

PRESTAGE CONSTRUCTION:

- PRESTAGE CONSTRUCTION SHALL CONSIST OF REMOVAL OF THE EXISTING SHOULDER AND EXISTING GUARDRAIL ON THE EAST SIDE OF THE PAVEMENT TO THE LIMITS SHOWN ON THE PLANS, TEMPORARILY FILLING THE EXISTING APPROACH INLET WITH SAND, AND CONSTRUCTING THE WIDENING NECESSARY FOR STAGE 1 TRAFFIC.
- THE PROPOSED WIDENING SHALL CONSIST OF HOT-MIX ASPHALT BASE COURSE - 10 1/2" AND SHALL INCLUDE PLACING EARTH EXCAVATION AGAINST THE WIDENING TO DRAIN.
- TRAFFIC CONTROL FOR THIS WORK SHALL BE IN ACCORDANCE WITH THE APPLICABLE PORTIONS OF TRAFFIC CONTROL AND PROTECTION, STANDARD 701326. ONE LANE OF TRAFFIC IN BOTH DIRECTIONS SHALL BE OPEN TO TRAFFIC AT ALL TIMES DURING THE PRESTAGE CONSTRUCTION.

STAGE I CONSTRUCTION:

- STAGE I CONSTRUCTION SHALL CONSIST OF STAGE I BRIDGE REPAIRS, REMOVAL OF THE EXISTING SHOULDER AND GUARDRAIL ON THE WEST SIDE OF THE PAVEMENT TO THE LIMITS SHOWN IN THE PLANS, CONSTRUCTING THE WIDENING NECESSARY FOR STAGE II TRAFFIC, GUARDRAIL UPGRADE, AND PLACING THE PROPOSED AGGREGATE SHOULDER.
- THE PROPOSED WIDENING SHALL CONSIST OF HOT-MIX ASPHALT BASE COURSE - 10 1/2" AND SHALL INCLUDE PLACING EARTH EXCAVATION AGAINST THE WIDENING TO DRAIN.
- TRAFFIC CONTROL FOR THIS WORK SHALL BE IN ACCORDANCE WITH THE APPLICABLE PORTIONS OF TRAFFIC CONTROL AND PROTECTION, STANDARD 701321.

STAGE II CONSTRUCTION:

- STAGE II CONSTRUCTION SHALL CONSIST OF STAGE II BRIDGE REPAIRS, GUARDRAIL UPGRADE, AND REMOVAL OF THE TEMPORARY SANDFILL FOR THE INLET. THE CONTRACTOR SHALL ENSURE THAT PROPER DRAINAGE IS RESTORED TO THE INLET AND PIPE PRIOR TO COMPLETION OF STAGE II CONSTRUCTION.
- TRAFFIC CONTROL FOR THIS WORK WILL BE IN ACCORDANCE WITH THE APPLICABLE PORTIONS OF TRAFFIC CONTROL AND PROTECTION, STANDARD 701321.

NOTES:

- CONFLICTING PAVEMENT MARKING SHALL BE REMOVED PRIOR TO PLACING PAVEMENT MARKING NECESSARY FOR STAGE CONSTRUCTION. THE COST FOR THIS SHALL BE INCLUDED IN THE APPLICABLE TRAFFIC CONTROL AND PROTECTION STANDARD.
- THIS PROJECT WILL REQUIRE TEMPORARY RUMBLE STRIP.
- THE BOTTOM 6" OF THE TEMPORARY CONCRETE BARRIER SHALL BE PAINTED WITH TEMPORARY PAVEMENT MARKING "WHITE". THE COST FOR THIS SHALL BE CONSIDERED AS INCLUDED IN THE COST OF TEMPORARY CONCRETE BARRIER.
- IF THE CONTRACTOR CHOOSES THE OPTION OF SAND MODULE IMPACT ATTENUATORS THEN THE LAYOUT SHOWN WILL BE USED.
- PLACING AND REMOVAL OF THE TEMPORARY SAND FILL FOR THE EXISTING INLETS WILL NOT BE PAID FOR SEPARATELY BUT SHALL BE CONSIDERED AS INCLUDED IN THE COST OF THE CONTRACT AND NO ADDITIONAL COMPENSATION WILL BE ALLOWED.

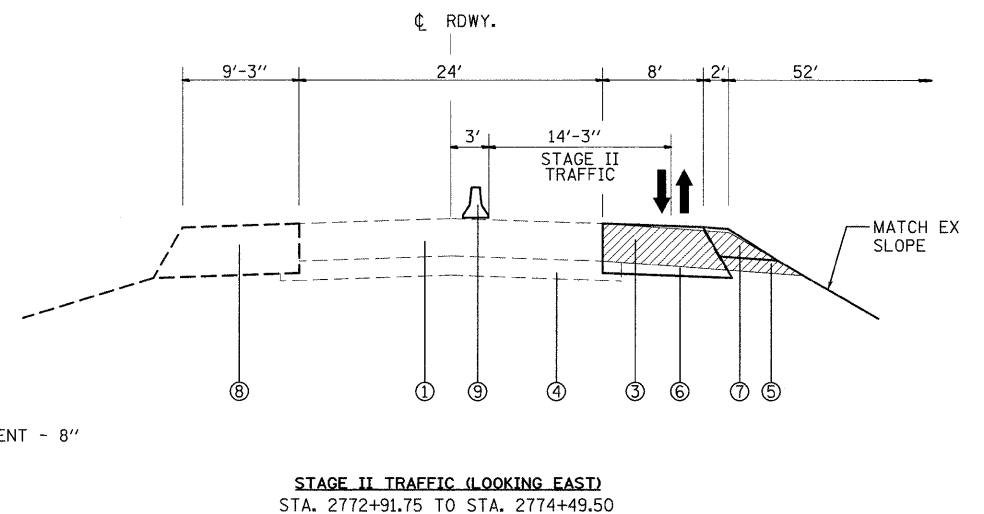
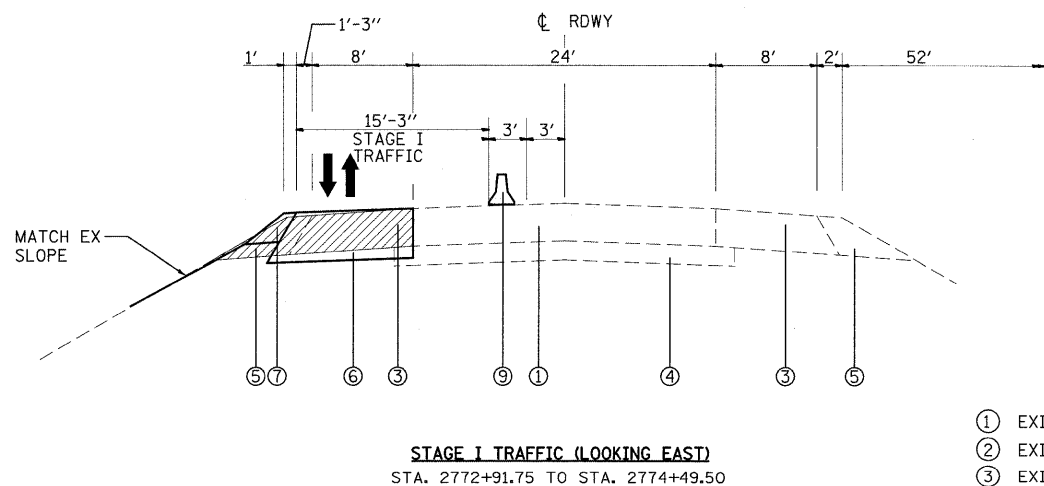
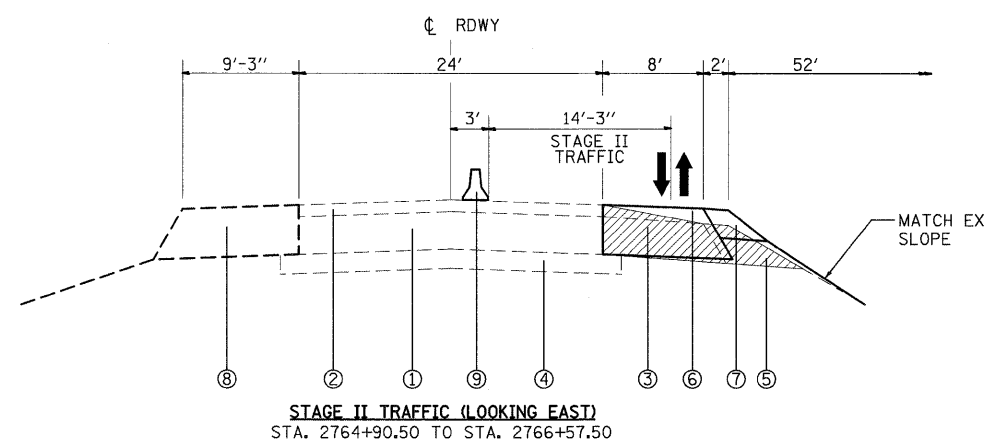
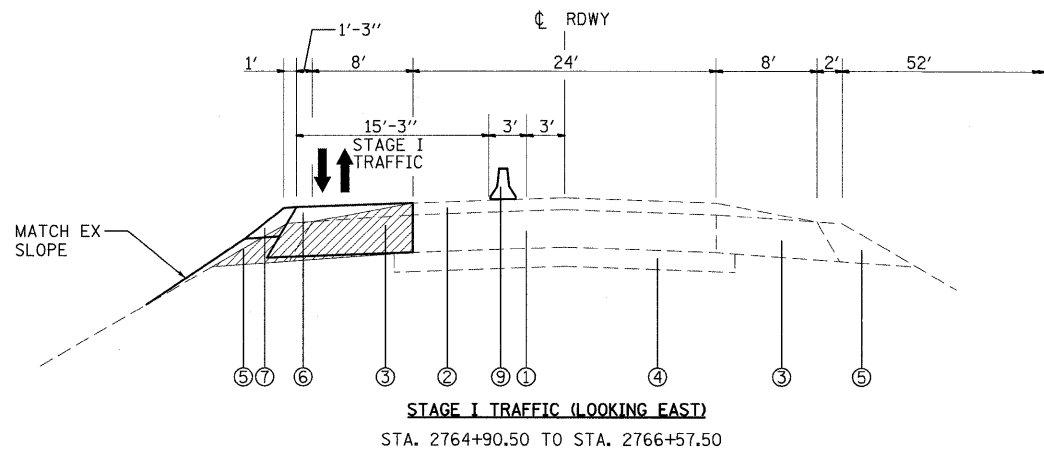

LEGEND

- ① EXISTING CONTINUOUSLY REINFORCED P.C.C. PAVEMENT - 8"
- ② EXISTING HMA RESURFACING - 3"
- ③ EXISTING HMA SHOULDER - 8"
- ④ EXISTING STABILIZED SUB-BASE - 4"
- ⑤ EXISTING AGGREGATE SHOULDER
- ⑥ PROPOSED HMA BASE COURSE WIDENING - 10 1/2"
- ⑦ PROPOSED AGGREGATE SHOULDER, TYPE B - 6"
- ⑧ HMA BASE COURSE WIDENING PLACED IN PRESTAGE CONSTRUCTION
- ⑨ TEMPORARY CONCRETE BARRIER

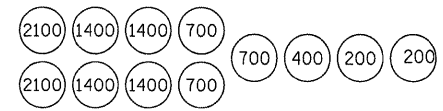

FILE NAME =	USER NAME = manntm	DESIGNED -	REVISED -	STATE OF ILLINOIS DEPARTMENT OF TRANSPORTATION	STAGE CONSTRUCTION - LOCATON 2	F.A.P. RTE.	SECTION	COUNTY	TOTAL SHEETS	SHEET NO.
cz:\pwork\pwidot\manntm\dms52470\p110207b.dgn	DRAWN -	REVISED -	327			14-12BR-1	CLINTON	72	38	
PLOT SCALE = 20.20000 ' / IN.	CHECKED -	REVISED -	CONTRACT NO. 76B27							
PLOT DATE = 12/23/2009	DATE -	REVISED -	FED. ROAD DIST. NO. ILLINOIS FED. AID PROJECT							
				SCALE: NO SCALE	SHEET NO. 1 OF 7 SHEETS	STA.	TO STA.			