

- LEGEND**
- ① PROPOSED HOT-MIX ASPHALT SURFACE REMOVAL - 1 1/2"
 - ② PROPOSED HOT-MIX ASPHALT SURFACE COURSE, MIX "D", N70
 - ③ PROPOSED SHOULDER REMOVAL
 - ④ PROPOSED HOT-MIX ASPHALT SHOULDER 6 1/2"
 - ⑤ PROPOSED AGGREGATE SHOULDER, TYPE B
 - ▨ PROPOSED EARTH EXCAVATION
 - ▩ PROPOSED MEDIAN REMOVAL

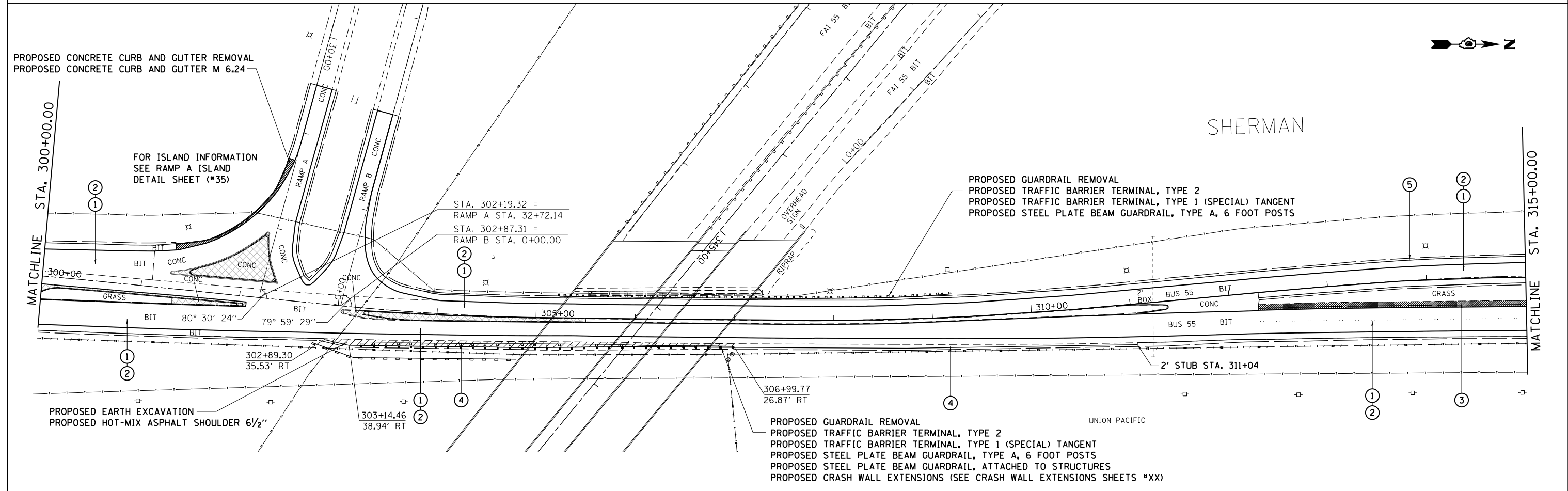
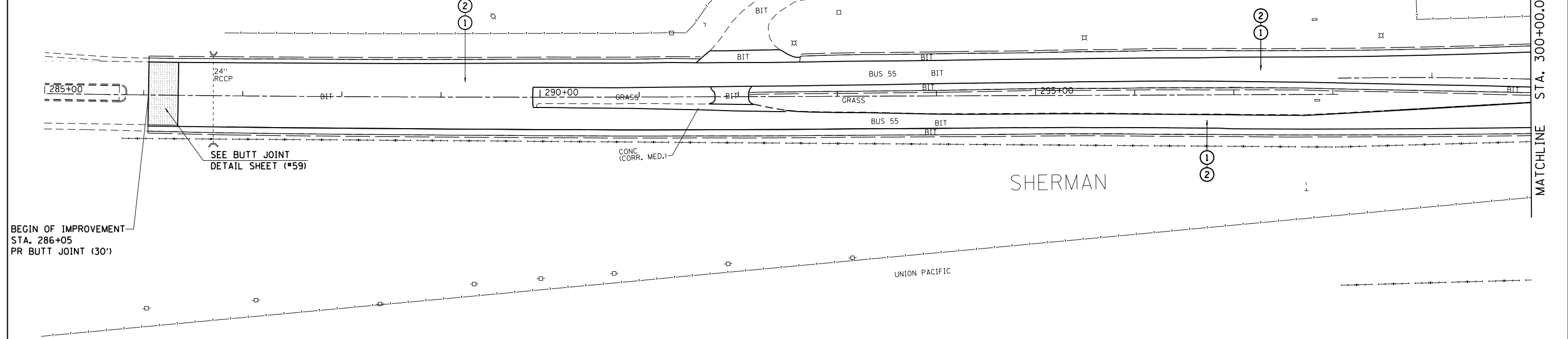

FILE NAME =	USER NAME = sparksgw	DESIGNED -	REVISED -	STATE OF ILLINOIS DEPARTMENT OF TRANSPORTATION	BUSINESS LOOP 55 PLAN SHEETS			F.A.P. RTE.	SECTION	COUNTY	TOTAL SHEETS	SHEET NO.
Default	ei:\pw\work\p\idot\sparksgw\10306018\0672\F50-Sht-50-Pln.dgn	DRAWN -	REVISED -					666	(26)RS,I	SANGAMON	116	25
	PLOT SCALE = 100.0000' / 1" =	CHECKED -	REVISED -		CONTRACT NO. 72F50			ILLINOIS FED. AID PROJECT				
	PLOT DATE = Dec-06-2013 09:53:50AM	DATE -	REVISED -		SCALE:	SHEET	OF SHEETS	STA.	TO STA.			