

SEC. 12, T. 19 N, R. 9 E.

30-21-12-400-002  
MERRYMAN, SHIRLEY H.  
5730008

30-21-12-400-001  
SMITH, LORENE RUBY  
5730007

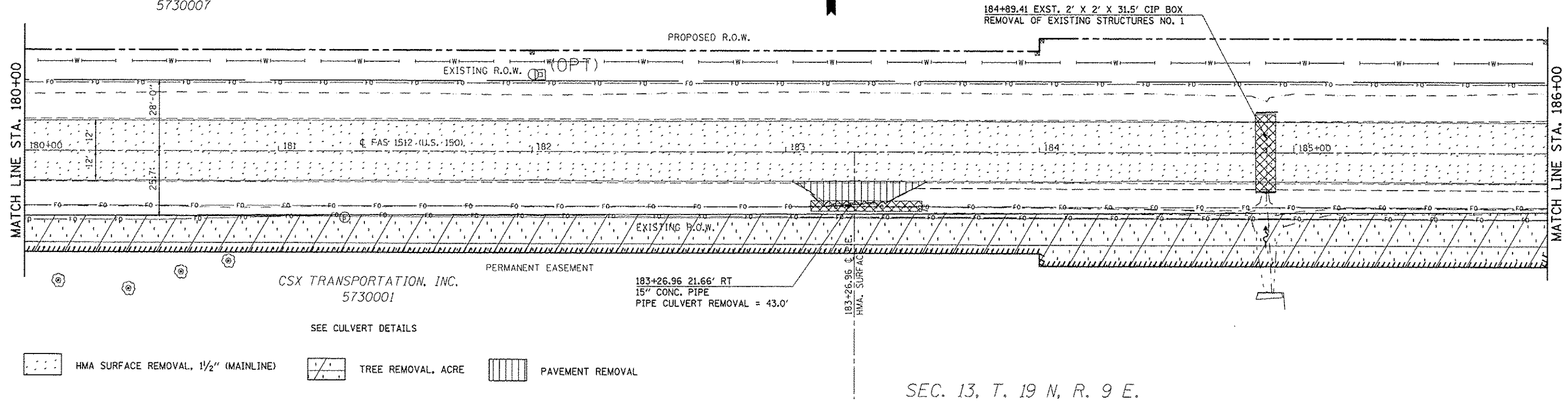

SEC. 13, T. 19 N, R. 9 E.

SEC. 12, T. 19 N, R. 9 E.

30-21-12-400-002  
MERRYMAN, SHIRLEY H.  
5730008

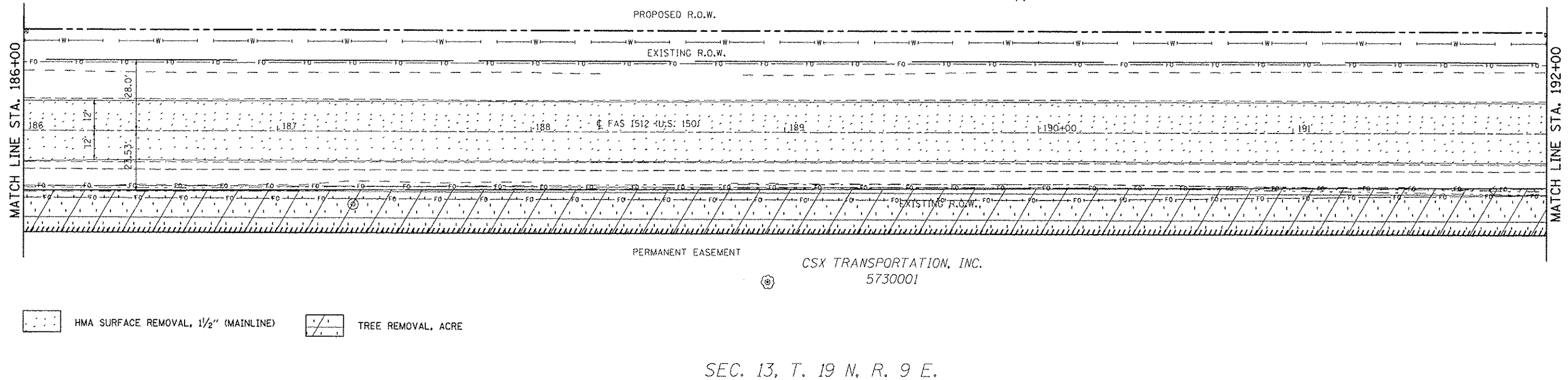

SEC. 13, T. 19 N, R. 9 E.

FILE NAME : c:\pwork\pwork\carrlock\j\18120316\0270663-ht-removal.dgn	USER NAME : carrlock_jd	DESIGNED : JMS	REVISED :	<b>STATE OF ILLINOIS DEPARTMENT OF TRANSPORTATION</b>	<b>REMOVAL DETAILS US 150 MAINLINE</b>	F.A.U. RTE. :	SECTION :	COUNTY :	TOTAL SHEETS :	SHEET NO. :
PLOT SCALE : 48.0000 / 1" = 48'	CHECKED :	REVISI	REVISI			FAU T152 & FAS 1512	CHAMPAIGN	551	50	
PLOT DATE : 10/18/2013	DATE : 051011	REVISI	REVISI			CONTRACT NO. 70663		[ILLINOIS] FED. AID PROJECT		
						SCALE: 1:20	SHEET NO. 8 OF 27 SHEETS	STA. 180+00.00 TO STA. 192+00.00		