

DATE	
BY	
PLAN	
NO.	
DATE	
BY	
PROFILE	
NO.	
DATE	
BY	

DATE	
BY	
PROFILE	
NO.	
DATE	
BY	

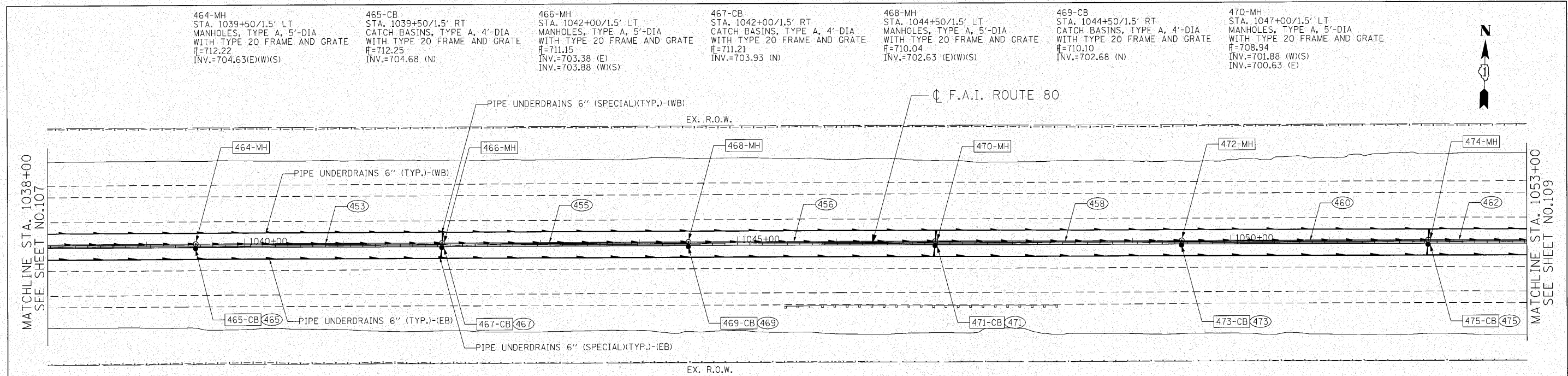

453 STORM SEWERS, CLASS A, TYPE 2, 24" 250' @ 0.30% TBF=185 CY

455 STORM SEWERS, CLASS A, TYPE 2, 30" 250' @ 0.30% TBF=190 CY

456 STORM SEWERS, CLASS A, TYPE 2, 30" 250' @ 0.30% TBF=170 CY

458 STORM SEWERS, CLASS A, TYPE 2, 30" 250' @ 0.30% TBF=219 CY

460 STORM SEWERS, CLASS A, TYPE 2, 36" 250' @ 0.30% TBF=221 CY

462 STORM SEWERS, CLASS A, TYPE 2, 36" 150' @ 0.30% TBF=230 CY

465, 467, 469 STORM SEWERS, CLASS A, TYPE 2, 12" 5' @ 1.00%

471-CB STA. 1047+00/1.5' RT CATCH BASINS, TYPE A, 4'-DIA WITH TYPE 20 FRAME AND GRATE F=708.97 INV.=701.93 (N)

472-MH STA. 1049+50/1.5' LT MANHOLES, TYPE A, 5'-DIA WITH TYPE 20 FRAME AND GRATE F=707.79 INV.=699.38 (E) INV.=699.88 (W)(S)

473-CB STA. 1049+50/1.5' RT CATCH BASINS, TYPE A, 4'-DIA WITH TYPE 20 FRAME AND GRATE F=707.83 INV.=699.93 (N)

474-MH STA. 1052+00/1.5' LT MANHOLES, TYPE A, 5'-DIA WITH TYPE 20 FRAME AND GRATE F=706.66 INV.=695.63 (E) INV.=698.63 (W)(S)

475-CB STA. 1052+00/1.5' RT CATCH BASINS, TYPE A, 4'-DIA WITH TYPE 20 FRAME AND GRATE F=706.69 INV.=698.68 (N)

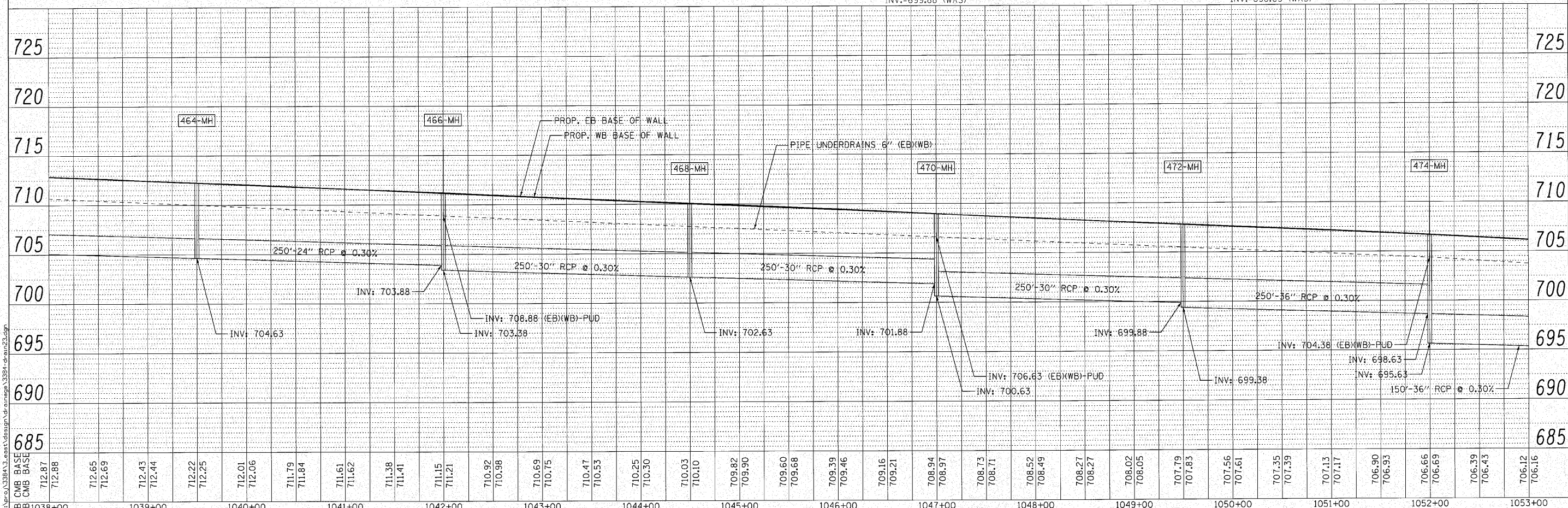

ENGINEERING CONSULTANT	USER NAME = jk,jeliman	DESIGNED - CRC	REVISED -	STATE OF ILLINOIS DEPARTMENT OF TRANSPORTATION F.A.I. 80 FROM NS RAILROAD TO US 45 PROPOSED DRAINAGE PLAN AND PROFILE	F.A.I. RTE. 80	SECTION 99(5&5-1) Y-1	COUNTY WILL	TOTAL SHEETS 309	SHEET NO. 108	
CONTRACT NO. 60M59	ILLINOIS FED. AID PROJECT	SCALE: 1" = 50'	SHEET NO. 108 OF		SHEETS	STA. 1038+00	TO STA. 1053+00			
CONTRACT NO. 60M59	ILLINOIS FED. AID PROJECT									

Corba Group, Inc.
CONSULTING ENGINEERS
1507 North Cumberland Avenue, Suite 402
Chicago, Illinois 60642
Tel: 773.775.4000 Fax: 773.775.4014
Email: chicago@corba.com

DESIGNED - CRC	REVISED -
DRAWN - JMK	REVISED -
CHECKED - MRJ	REVISED -
DATE - 10/27/2010	REVISED -

PLOT SCALE = 50.0000' / IN.
PLOT DATE = 10/28/2010

F.A.I. RTE. 80	SECTION 99(5&5-1) Y-1	COUNTY WILL	TOTAL SHEETS 309	SHEET NO. 108
CONTRACT NO. 60M59				
ILLINOIS FED. AID PROJECT				