

BY	DATE
FINAL SURVEY	SURVEYED
NOTE BOOK	PLOTTED
NO.	DATE
	AREAS CHECKED

BY	DATE
ORIGINAL SURVEY	SURVEYED
NOTE BOOK	PLOTTED
NO.	DATE
	AREAS CHECKED

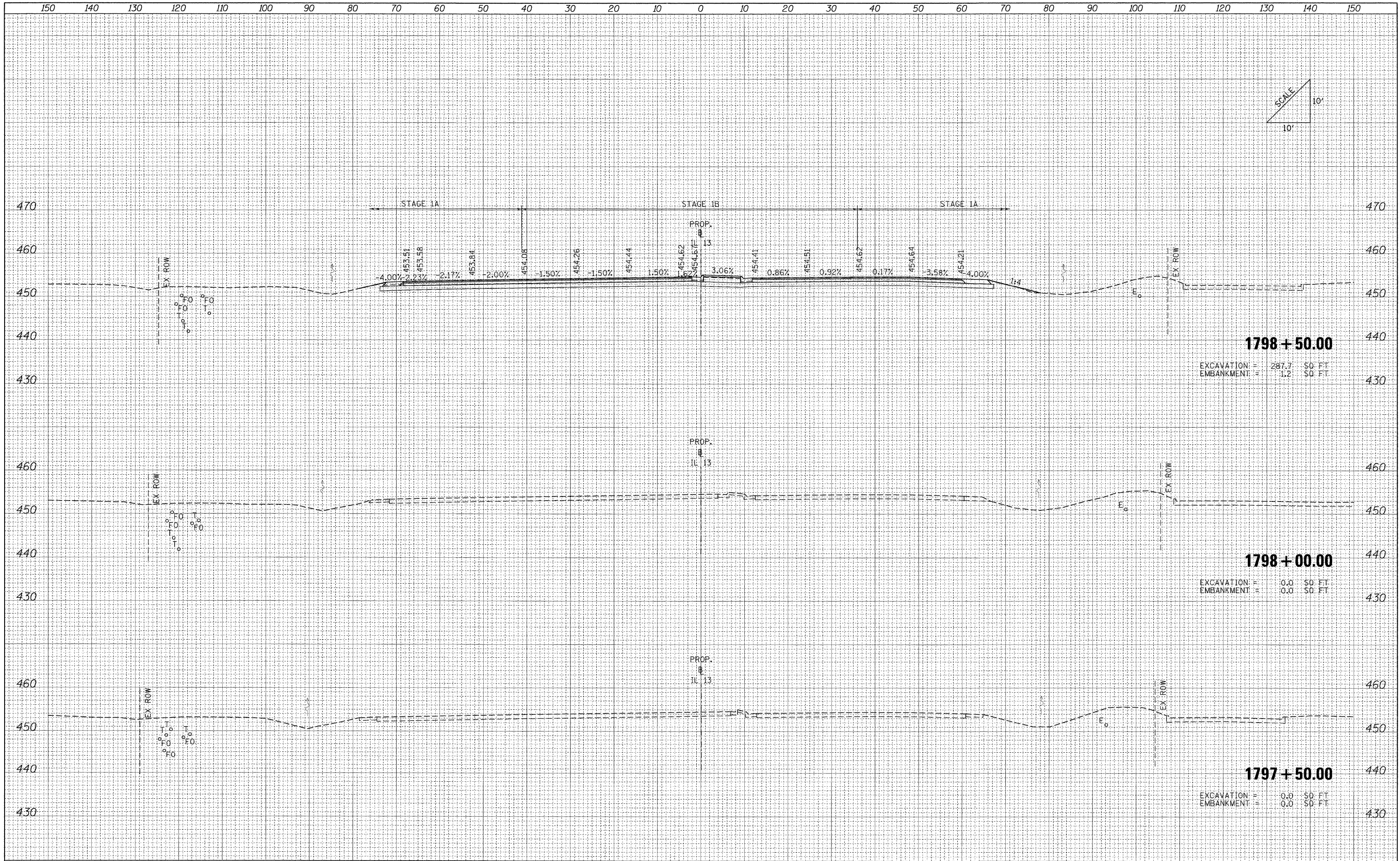

FILE NAME = ...D978182=ht-XCS\_IL13.dgn

USER NAME = Rob Heady	DESIGNED - MJO	REVISED -
PLOT SCALE = 10,0000' / IN.	DRAWN - MJO	REVISED -
PLOT DATE = 10/10/2011	CHECKED - BJD	REVISED -
	DATE - 10/07/11	REVISED -

**STATE OF ILLINOIS  
DEPARTMENT OF TRANSPORTATION**

**CROSS SECTIONS: F.A.P 331 (IL 13)**

SCALE: SHEET NO. OF SHEETS STA. 1797+50.00 TO STA. 1798+50.00

F.A. RTE.	SECTION	COUNTY	TOTAL SHEETS	SHEET NO.
• 01-6-2HKB-2, HB-1,2; (IX-1R-1	WILLIAMSON	968	844	
• F.A.I. 57 AND F.A.P. 331	CONTRACT NO. 78182			
FED. ROAD DIST. NO.	ILLINOIS FED. AID PROJECT			