

F.A.P. RTE.	SECTION	COUNTY	TOTAL SHEETS	SHEET NO.
307	130 R-2	DUPAGE, KANE	647	99
STA.		TO STA.		
FED. ROAD DIST. NO.		ILLINOIS FED. AID PROJECT		

62410

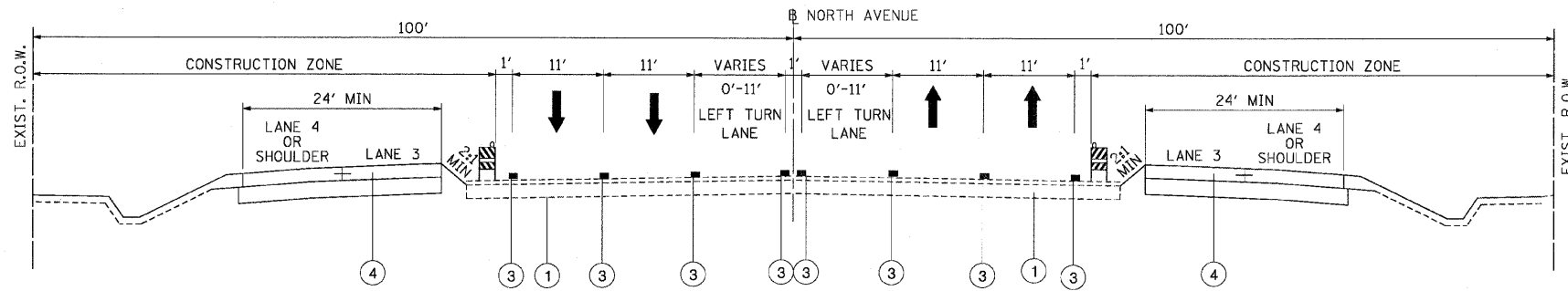

CONSTRUCTION STAGING TYPICAL SECTION
 NORTH AVENUE, STAGE 1 & 1A

STA. 3292+10 TO STA. 3348+00

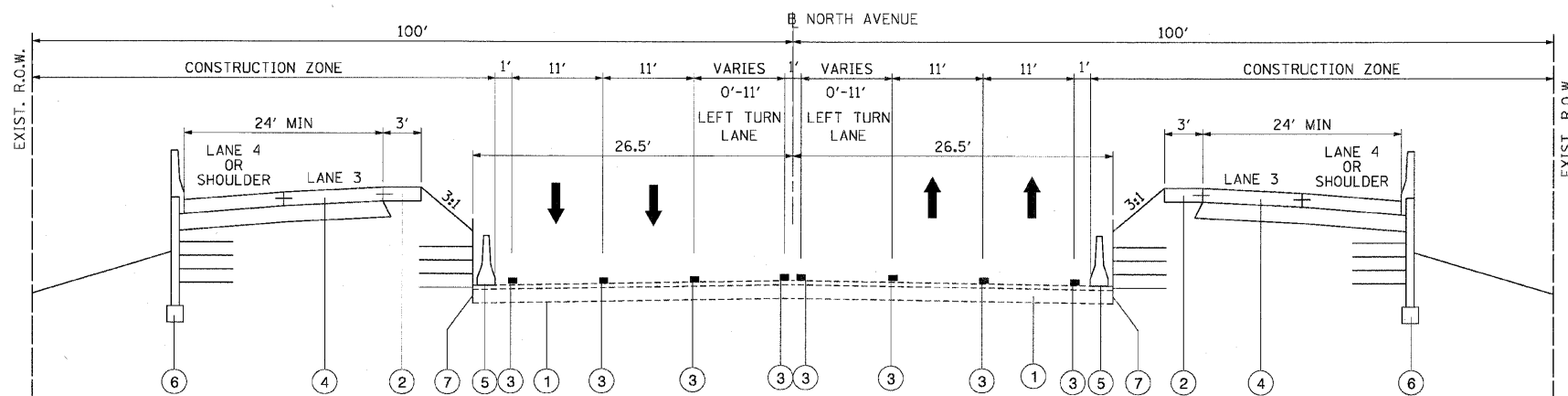

CONSTRUCTION STAGING TYPICAL SECTION
 NORTH AVENUE, STAGE 1 & 1A

STA. 3348+00 TO STA. 3359+00

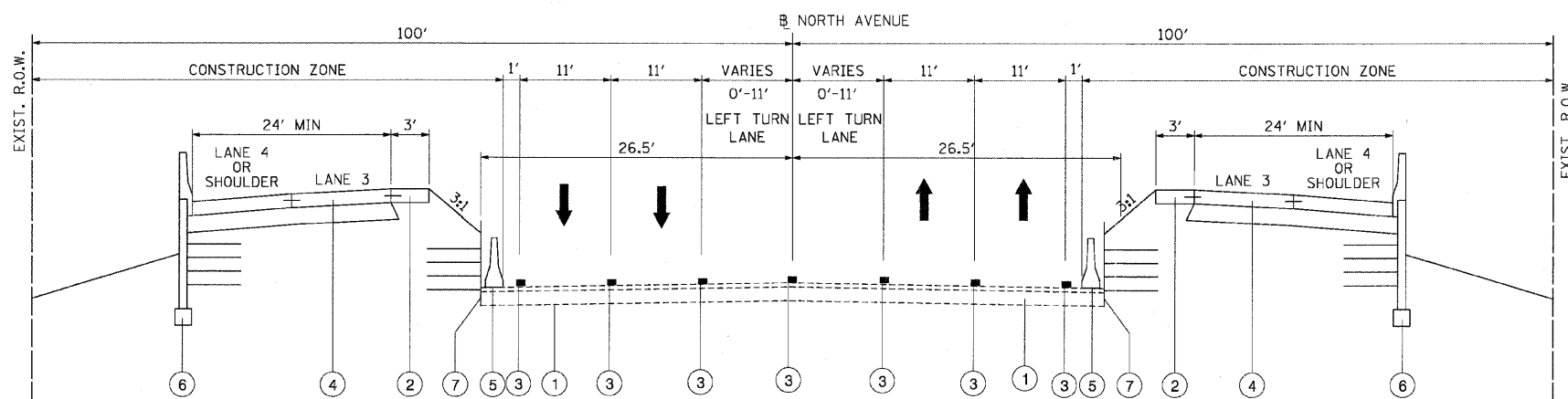

CONSTRUCTION STAGING TYPICAL SECTION
 NORTH AVENUE, STAGE 1 & 1A

STA. 3359+00 TO STA. 3368+00

M.O.T. LEGEND:

- ① EXISTING PAVEMENT
- ② TEMPORARY PAVEMENT
- ③ TEMPORARY PAVEMENT MARKING
- ④ PROPOSED PAVEMENT
- ⑤ TEMPORARY BARRIER WALL
- ⑥ PROPOSED MSE WALL
- ⑦ TEMPORARY MSE WALL/TEMPORARY SOIL RETENTION SYSTEM
 (SEE STRUCTURAL SHEETS FOR LOCATION)



REVISIONS		ILLINOIS DEPARTMENT OF TRANSPORTATION F.A.P. ROUTE 307 (ILLINOIS ROUTE 64)
NAME	DATE	
		SUGGESTED STAGES OF CONSTRUCTION AND TRAFFIC CONTROL TYPICAL SECTIONS - STAGE 1 & 1A

SCALE: VERT: NONE
 HORIZ: NONE
 DATE: MAY 13, 2011

DRAWN BY: KK - JWM
 CHECKED BY: MD