

INDEX OF SHEETS

SHEET NO.	TITLE
1	COVER SHEET
2	INDEX OF SHEETS, STATE STANDARDS, AND GENERAL NOTES
3-5	SUMMARY OF QUANTITIES
6	TYPICAL SECTIONS
7-8	ROADWAY AND PAVEMENT MARKING PLANS
9-16	ADA RAMP DETAILS
17-18	TRAFFIC SIGNALS - HEMINGWAY DRIVE
19-20	TRAFFIC SIGNALS - TRITON COLLEGE NORTH ENTRANCE
21-22	TRAFFIC SIGNALS - RIVER RD
23	DETAILS FOR FRAMES AND LIDS ADJUSTMENT WITH MILLING (BD-08)
24	PAVEMENT PATCHING FOR HMA SURFACED PAVEMENT (BD-22)
25	CURB OR CURB AND GUTTER REMOVAL AND REPLACEMENT (BD-24)
26	BUTT JOINT AND HMA TAPER DETAILS (BD-32)
27	PROJECT DETAIL FOR SINGLE PERPENDICULAR CURB RAMP (PD-01)
28	TRAFFIC CONTROL AND PROTECTION FOR SIDE ROADS, INTERSECTIONS, AND DRIVEWAYS (TC-10)
29	TYPICAL APPLICATIONS RAISED REFLECTIVE PAVEMENT MARKERS (SNOW-PLOW RESISTANT) (TC-11)
30	TYPICAL PAVEMENT MARKINGS (TC-13)
31	TRAFFIC CONTROL AND PROTECTION AT TURN BAYS (TO REMAIN OPEN TO TRAFFIC) (TC-14)
32	SHORT TERM PAVEMENT MARKING LETTERS AND SYMBOLS (TC-16)
33	ARTERIAL ROAD INFORMATION SIGN (TC-22)
34	DRIVEWAY ENTRANCE SIGNING (TC-26)
35-41	STANDARD TRAFFIC SIGNAL DESIGN DETAILS (TS-05)
42	DETECTOR LOOP INSTALLATION DETAILS FOR ROADWAY RESURFACING (TS-07)

HIGHWAY STANDARDS

STANDARD NO.	DRAWING NAME
000001-08	STANDARD SYMBOLS, ABBREVIATIONS AND PATTERNS
424001-12	PERPENDICULAR CURB RAMPS FOR SIDEWALKS
442201-03	CLASS C AND D PATCHES
606001-08	CONCRETE CURB TYPE B AND COMBINATION CONCRETE CURB AND GUTTER
701006-05	OFF-ROAD OPERATIONS, 2L, 2W, 15' (4.5 M) TO 24" (600 MM) FROM PAVEMENT EDGE
701101-05	OFF-ROAD OPERATIONS, MULTILANE, 15' (4.5 M) TO 24" (600 MM) FROM PAVEMENT EDGE
701427-05	LANE CLOSURE, MULTILANE, INTERMITTENT OR MOVING OPERATION, FOR SPEEDS ≤ 40 MPH
701602-10	URBAN LANE CLOSURE, MULTILANE, 2W WITH BIDIRECTIONAL LEFT TURN LANE
701606-10	URBAN SINGLE LANE CLOSURE, MULTILANE, 2W WITH MOUNTABLE MEDIAN
701611-01	URBAN HALF ROAD CLOSURE, MULTILANE, 2W WITH MOUNTABLE MEDIAN
701701-10	URBAN LANE CLOSURE, MULTILANE INTERSECTION
701801-06	SIDEWALK, CORNER OR CROSSWALK CLOSURE
701901-10	TRAFFIC CONTROL DEVICES
780001-05	TYPICAL PAVEMENT MARKINGS
781001-04	TYPICAL APPLICATIONS RASIED REFELCTIVE PAVEMENT MARKERS
886001-01	DETECTOR LOOP INSTALLATIONS
886006-01	TYPICAL LAY OUTS FOR DETECTION LOOPS

GENERAL NOTES

1. THE CONTRACTOR SHALL NOT BE ALLOWED TO SET UP YARD OR FIELD OFFICE ON STATE PROPERTY WITHOUT WRITTEN PERMISSION FROM THE DEPARTMENT.
2. IT SHALL BE THE CONTRACTOR'S RESPONSIBILITY TO VERIFY ALL DIMENSIONS AND CONDITIONS EXISTING IN THE FIELD PRIOR TO BEGINNING CONSTRUCTION AND ORDERING MATERIALS.
3. THE CONTRACTOR SHALL CONTACT KALPANA KANNAN-HOSADURGA, THE DISTRICT ONE TRAFFIC CONTROL SUPERVISOR AT KALPANA.KANNAN-HOSADURGA@ILLINOIS.GOV A MINIMUM OF 72 HOURS IN ADVANCE OF BEGINNING WORK.
4. MILLING AND PAVING OPERATIONS MUST INCLUDE THE APPROACHES OF THE RAILROAD TRACKS, UP TO THE TRACK PANELS.
5. TEN (10) FOOT TRANSITIONS SHALL BE USED TO MATCH PROPOSED CURB AND GUTTER AND MEDIAN ITEMS OF WORK TO EXISTING CURBS AND GUTTER AND MEDIANS IN THE FIELD, UNLESS OTHERWISE SHOWN.
6. ALL PAVEMENT PATCHING LOCATIONS WILL BE DETERMINED IN THE FIELD BY THE ENGINEER.
7. LOCATION OF COMBINATION CONCRETE CURB AND GUTTER REMOVAL AND REPLACEMENT [OR COMBINATION CURB AND GUTTER (THE TYPE SPECIFIED ON THE PLANS)], WILL BE DETERMINED IN THE FIELD BY THE ENGINEER.
8. DRAINAGE ADJUSTMENT OR RECONSTRUCTION LOCATIONS WILL BE DETERMINED IN THE FIELD BY THE ENGINEER.
9. FRAMES AND GRATES ADJUSTMENT OF PRIVATE UTILITIES WITHIN THE LIMITS OF THE IMPROVEMENTS SHALL BE DONE BY THEIR RESPECTIVE OWNERS AND ARE NOT PART OF THIS CONTRACT.
10. THE CONTRACTOR SHALL BE REQUIRED TO KEEP A RECORD OF THE LOCATIONS OF THE BURIED STRUCTURES ACCORDING TO THE STATION AND DISTANCE LEFT OR RIGHT OF THE CENTERLINE OF PAVEMENT. UPON COMPLETION OF THE WORK, THE CONTRACTOR SHALL DELIVER THE RECORD TO THE ENGINEER.
11. EXISTING BROKEN FRAMES AND LIDS SHALL BE REMOVED AND DISPOSED OF BY THE CONTRACTOR AND SHALL BE REPLACED AS DIRECTED BY THE ENGINEER. REPLACEMENT FRAMES AND LIDS WILL BE PAID FOR ACCORDING TO ARTICLE 109.04 OF THE STANDARD SPECIFICATIONS UNLESS A SEPARATE PAY ITEM HAS BEEN PROVIDED.
12. PAVEMENT MARKING TAPE, TYPE IV SHALL BE USED FOR SHORT TERM PAVEMENT MARKINGS ON ALL FINAL SURFACES.
13. THE RESIDENT ENGINEER SHALL CONTACT ABDULLA ALI, AREA TRAFFIC FIELD ENGINEER, VIA EMAIL AT ABDULLA.ALI@ILLINOIS.GOV A MINIMUM OF TWO (2) WEEKS PRIOR TO THE PLACEMENT OF PERMANENT PACEMENT MARKINGS.
14. SIDEWALK REMOVAL AND P.C.C. SIDEWALK 5" LOCATION SHALL BE DETERMINED BY THE RESIDENT ENGINEER.
15. BEFORE BEGINNING ANY WORK, THE CONTRACTOR SHALL RETAIN AND RECORD FOR FUTURE REFERENCE, ALL EXISTING PAVEMENT MARKING LINES (AND RAISED REFLECTIVE PAVEMENT MARKERS) IN ORDER THAT THESE LOCATIONS CAN BE RE-ESTABLISHED FOR STRIPING. EXCAT LOCATIONS OF ALL PAVEMENT MARKINGS SHALL BE SHOWN ON THE PLANS OR AS DIRECTED BY THE RESIDENT ENGINEER.
16. OVERNIGHT LANE CLOSURES SHALL NOT BE ALLOWED FOR REHABILITAION PROJECTS INVOLVING DAYTIME MILLING AND RESURFACING OPERATIONS AND CLASS D PATCHING UNLESS OTHER CONDITIONS WARRANT EXTENDED LANE CLOSURES AS DETERMINED AND APPROVED IN WRITING BY THE RESIDENT ENGINEER OR AS PROVIDED IN THE CONTRACT SPECIFICATIONS.
17. ALL MILLED SURFACES SHALL BE A UNIFORM CROSS SLOPE PER LANE AND FREE OF RIDGES BETWEEN PASSES. ANY DEVIATIONS SHALL BE CORRECTED AT NO COST TO THE DEPARTMENT.
18. THE CONTRACTOR SHALL CONTACT DIANE LEWIS, MANAGER PUBLIC WORKS, AT DIANE.LEWIS@CN.CA OR 248-296-0414 WHEN SUBMITTING THE RIGHT OF ENTRY APPLICATION FOR THE WISCONSIN CENTRAL LIMITED (WCL) RAILROAD TO HAVE THE APPLICATION FEE WAIVED.

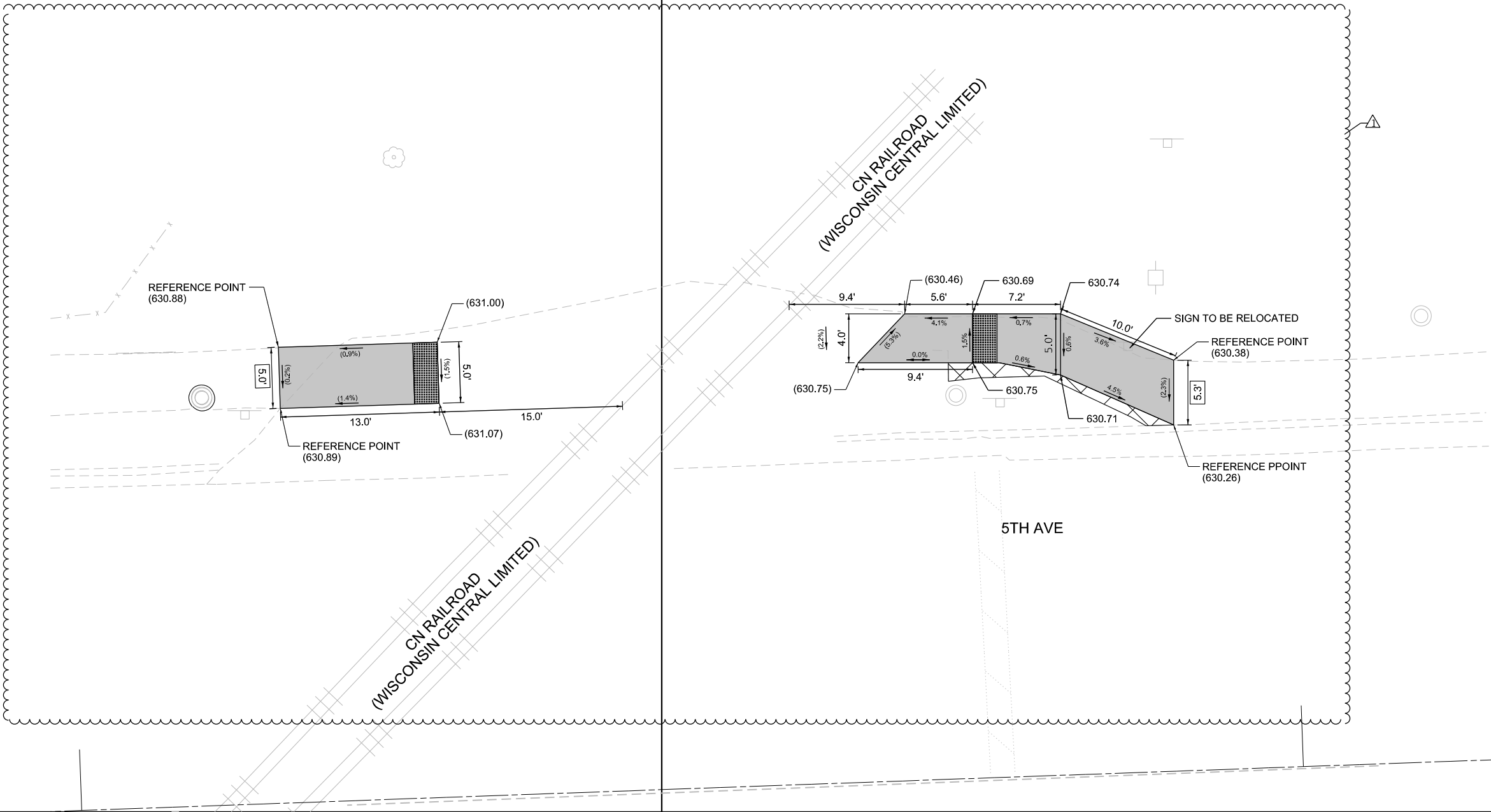
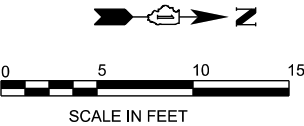

REFERENCE BENCHMARK: 1718, ELEV. 630.995

BENCHMARK: "X" CUT IN SIDEWALK

LOCATION: NORTHWEST CORNER OF 5TH AVENUE AND ENTRANCE TO HOSPITAL

LEGEND

XX.XX'

()

EXISTING LENGTH

EXISTING ELEVATION / SLOPE

PROPOSED SIDEWALK

DETECTABLE WARNINGS

SIDEWALK REMOVAL REPLACE WITH TOPSOIL AND SOD

DEPRESSED CURB AND GUTTER

PROPOSED SIDE CURB

PAVEMENT REMOVAL

1

REVISED SHEET 1/2/2024

MODEL: D:\refa\1
FILE: 11-22-2024\22-22-24\5-00 IDOT Various Phase 2 (PTB 206-202)MO 21 62X15DGN\CADD_Sheets\62X15-SHT-ADA-03.dgn

<div><div></div><div>INFRASTRUCTURE ENGINEERING INCORPORATED</div><div>1 South Wacker Suite 2650 Chicago, IL 60606</div><div>P 312.425.9568 F 312.425.9568 www.infrastructure-eng.com</div></div>	USER NAME = ALane	DESIGNED - JCS	REVISED - <div>ACL 12/10/2024</div>
		DRAWN - JCS	REVISED -
	PLOT SCALE = 10,0001' / in.	CHECKED - ACL	REVISED -
		DATE - 11/13/2024	

STATE OF ILLINOIS
DEPARTMENT OF TRANSPORTATION

ADA RAMP DETAILS	
5TH AVE AND CN RAILROAD	
SCALE: 1" = 10'	TO STA.

F.A.U. RTE.	SECTION	COUNTY	TOTAL SHEETS	SHEET NO.
2742	2024-990-RS,SW	COOK	41	11
CONTRACT NO. 62X15				
ILLINOIS FED. AID PROJECT				