

STATE OF ILLINOIS
DEPARTMENT OF TRANSPORTATION
DIVISION OF HIGHWAYS

**PROPOSED
HIGHWAY PLANS**

FAP ROUTE 63 (US 24-MAINE ST.) @ FAP 502 (IL 57, 3rd St.)
SECTION 78-2(TS-2, N, T, I)
PROJECT: NHF-0063 (059)
ADAMS COUNTY
C-96-032-08

F.A.P. RTE.	SECTION	COUNTY	TOTAL SHEETS	SHEET NO.
63	78-2(TS-2, N, T, I)	ADAMS	16	1
FED. ROAD DIST. NO.		ILLINOIS	CONTRACT NO. 72B72	

INDEX OF SHEETS

- 1 COVER SHEET
- 2 GENERAL NOTES
- 3-5 SUMMARY OF QUANTITIES
- 6 SCHEDULE OF QUANTITIES
- 7-8 PLAN SHEETS
- 9-12 DETAIL SHEETS
- 13 PAVEMENT MARKING PLAN
- 14-16 TRAFFIC SIGNAL DETAILS

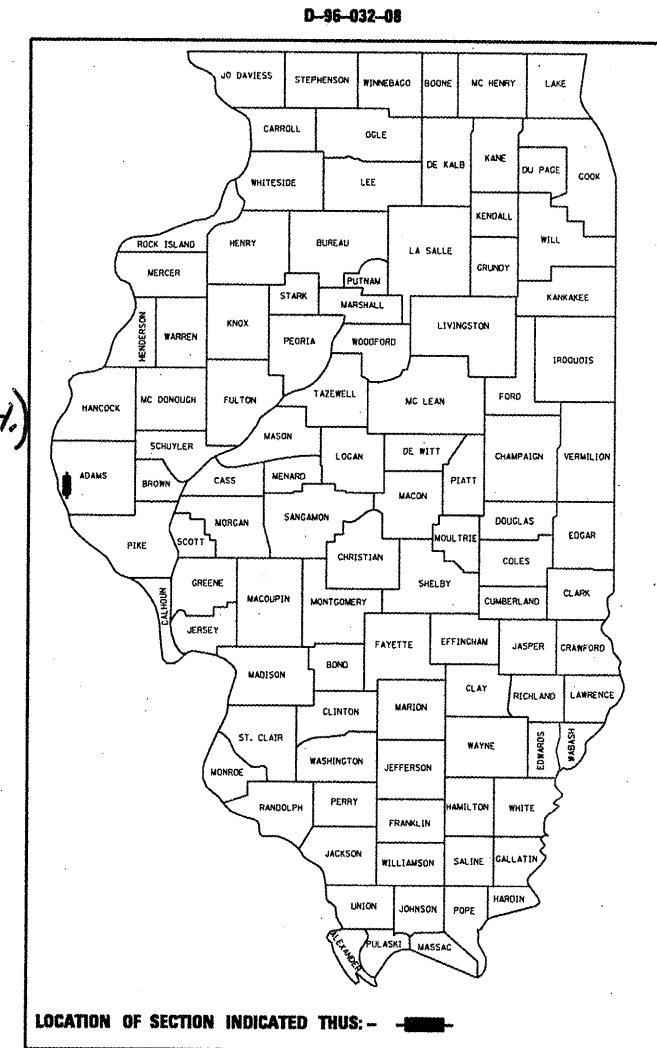

AADT = 6800 (2005)
MU = 475
SU = 525

STATE OF ILLINOIS
DEPARTMENT OF TRANSPORTATION
DIVISION OF HIGHWAYS

SUBMITTED Oct 10, 2008
Roger J. Dushell
DEPUTY DIRECTOR OF HIGHWAYS, REGION ENGINEER

December 5, 2008
Eric E. Horn
ENGINEER OF DESIGN AND ENVIRONMENT

December 5, 2008
Christine M. Reed
DIRECTOR OF HIGHWAYS, CHIEF ENGINEER

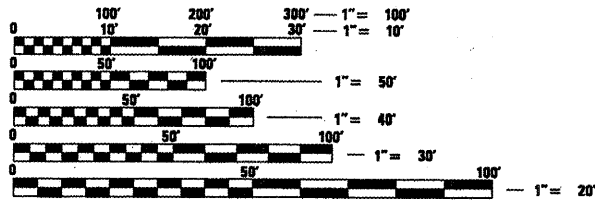

FULL SIZE PLANS HAVE BEEN PREPARED USING STANDARD ENGINEERING SCALES. REDUCED SIZED PLANS WILL NOT CONFORM TO STANDARD SCALES. IN MAKING MEASUREMENTS ON REDUCED PLANS, THE ABOVE SCALES MAY BE USED.

J.U.L.I.E.
JOINT UTILITY LOCATION INFORMATION FOR EXCAVATION
1-800-892-0123
OR 811

SQUAD LEADER: BRAD HEIMSNESS (217) 785-5338
PROJECT ENGINEER: JOHN NEGANGARD (217) 782-6990

CONTRACT NO. 72B72

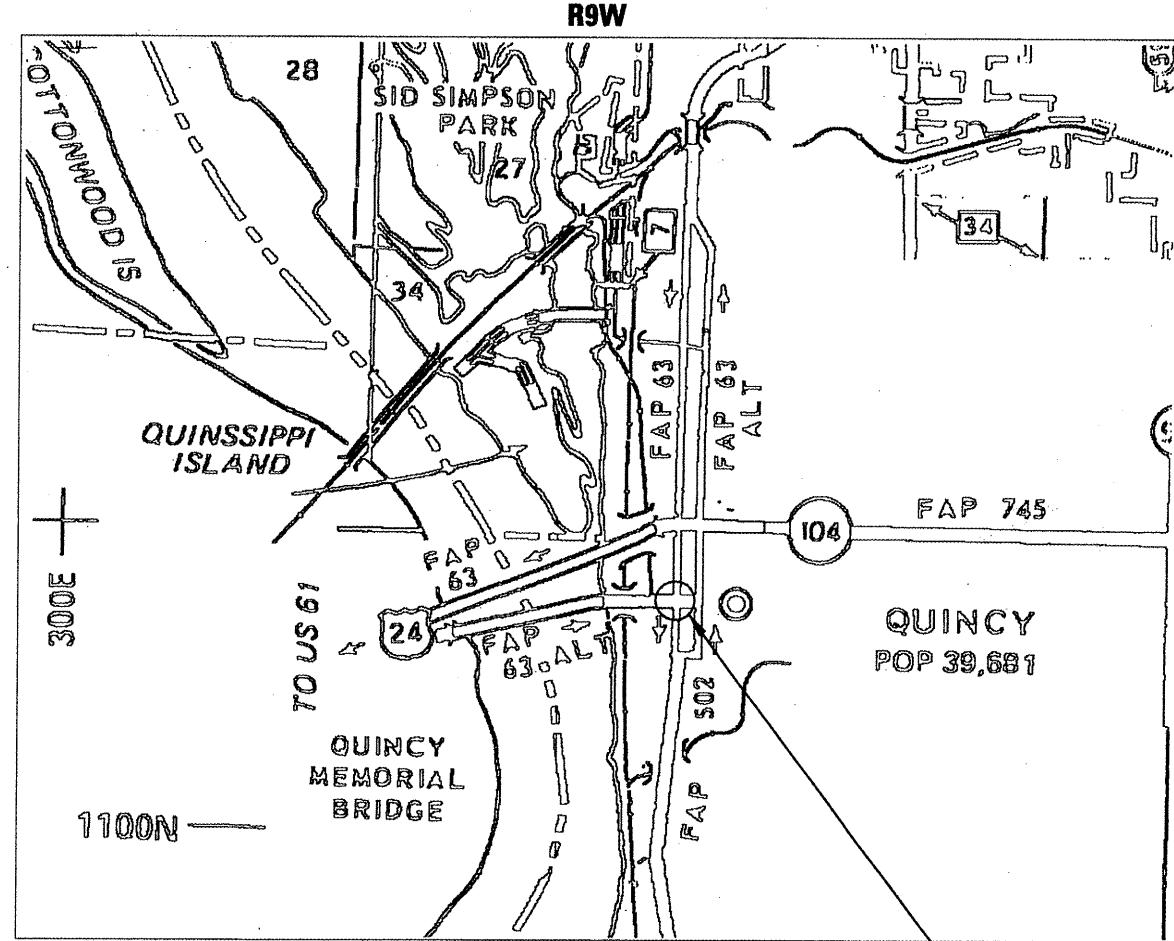

PROJECT LENGTH = 350.0'

PROJECT LOCATION
(INTERSECTION)

PRINTED BY THE AUTHORITY
OF THE STATE OF ILLINOIS

Rev 1

GENERAL NOTES:

1. ALL ELEVATIONS SHOWN IN THE PLANS ARE U. S. G. S. MEAN SEA LEVEL DATUM.
2. ANY REFERENCE TO THE STANDARDS THROUGHOUT THE PLANS SHALL BE INTERPRETED TO BE THE LATEST STANDARDS OF THE DEPARTMENT AS INCLUDED IN THE PLANS.
- 3 THE LOCATION OF THOSE BURIED AND ABOVE GROUND UTILITIES SHOWN ARE APPROXIMATE. THE CONTRACTOR SHALL BE RESPONSIBLE FOR PROTECTING UTILITY PROPERTY FROM CONSTRUCTION OPERATIONS AS OUTLINED IN ARTICLE 107.26 OF THE STANDARD SPECIFICATIONS. THE J. U. L. I. E. NUMBER IS (800) 892-0123. A MINIMUM OF 48 HOURS ADVANCE NOTICE IS REQUIRED, SEE SPECIAL PROVISIONS FOR STATUS OF UTILITIES, WITH UTILITY COMPANIES LISTED.
- 4 THE EXISTING ROAD SIGNS THAT INTERFERE WITH CONSTRUCTION SHALL BE RELOCATED AS DIRECTED BY THE ENGINEER. AFTER THE CONSTRUCTION IS COMPLETE, THE CONTRACTOR SHALL REPLACE THE SIGNS AS DIRECTED BY THE ENGINEER. THIS WORK WILL NOT BE PAID FOR SEPARATELY, BUT CONSIDERED INCLUDED IN THE CONTRACT UNIT BID PRICES.
- 5 ABANDONED UNDERGROUND UTILITIES THAT CONFLICT WITH THE CONSTRUCTION SHALL BE DISPOSED OF OUTSIDE THE LIMITS OF RIGHT-OF-WAY ACCORDING TO ARTICLE 202.03 OF THE STANDARD SPECIFICATIONS AND AS DIRECTED BY THE ENGINEER. THIS WORK WILL NOT BE PAID FOR SEPARATELY BUT SHALL BE CONSIDERED INCLUDED IN THE CONTRACT UNIT BID PRICE FOR EARTH EXCAVATION. NO ADDITIONAL COMPENSATION WILL BE ALLOWED.
- 6 CONTRACTOR SHALL COORDINATE WITH UTILITY COMPANIES ON VALVE OR MAN-HOLE ADJUSTMENTS PRIOR TO ANY EXCAVATION, OR REMOVAL WORK IN THOSE AREAS.
- 7 THE EXISTING TRAFFIC SIGNALS SHALL REMAIN OPERATIONAL DURING INSTALLATION OF THE PROPOSED TRAFFIC SIGNALS.
- 8 THE CONTRACTOR WILL BE RESPONSIBLE FOR THE TRAFFIC CONTROL DEVICES AT ALL TIMES DURING CONSTRUCTION ACTIVITIES AND SHALL COORDINATE WORK IN ORDER TO KEEP HAZARD TRAFFIC INCONVENIENCES TO A MINIMUM.
- 9 ALL SIDEWALKS SHALL BE BUILT WITH A MAXIMUM CROSS SLOPE OF 2% UNLESS OTHERWISE NOTED.
- 10 ALL PAVEMENT MARKINGS SHALL BE VERIFIED BY THE ENGINEER PRIOR TO THEIR PLACEMENT
- 11 ANY EXISTING PAVEMENT OR OTHER ROADWAY FEATURES DAMAGED DUE TO THE CONTRACTORS OPERATIONS, NOT OTHERWISE SCHEDULED TO BE REPLACED, SHALL BE REPLACED AT THE EXPENSE OF THE CONTRACTOR.
- 12 ALL MULCH REQUIRED AFTER RETAINING WALL HAS BEEN RE-BUILT WILL BE INCIDENTAL TO THIS CONTRACT. IF MORE MULCH IS NEEDED IT WILL BE REPLACED WITH LIKE KIND AT CONTRACTORS EXPENSE.

COMMITMENTS

1. THE FIELD/RESIDENT ENGINEER SHALL CONTACT STUDIES AND PLANS CONCERNING ANY MAJOR PLAN CHANGES TO MAKE SURE NO PREVIOUS COMMITMENTS (NOT LISTED) WERE MADE AFFECTING THE DESIGN AND ALLOW AN IMPROVED DESIGN FOR FUTURE PROJECTS.

HIGHWAY STANDARDS

000001-05	701801-04
424001-05	701901-01
602601-02	780001-02
604066-02	814001-02
606001-04	873001-02
606006-02	877001-04
606201-02	877002-01
606301-04	878001-07
701701-00	880006-01

EXAMINED May 6 2008

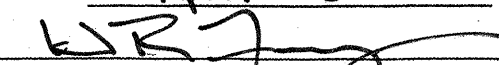
 PROGRAM IMPLEMENTATION ENGINEER

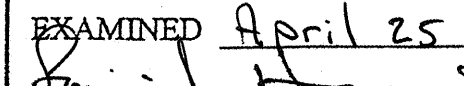
EXAMINED April 28 2008

 PROGRAM DEVELOPMENT ENGINEER

DISTRICT SIX
 EXAMINED April 25 2008

 OPERATIONS ENGINEER

SUMMARY OF QUANTITIES

PAYCODE	ITEM DESCRIPTION	UNIT	URBAN		PEDESTRIAN RAMPS	CHANNEL- IZATION
			80% FED	20% STATE		
			TOTAL QUANTITIES	Y031-1F	SFTY-1A	A000-1A
				TRAFFIC SIGNALS		
31101200	SUB-BASE GRANULAR MATERIAL, TYPE B 4"	SQ YD	34.0			34.0
42400100	PORTLAND CEMENT CONCRETE SIDEWALK 4 INCH	SQ FT	719.0		719.0	
42400800	DETECTABLE WARNINGS	SQ FT	140.0		140.0	
44000100	PAVEMENT REMOVAL	SQ YD	32.0			32.0
44000300	CURB REMOVAL	FOOT	97.0			97.0
44000500	COMBINATION CURB AND GUTTER REMOVAL	FOOT	41.0			41.0
44000600	SIDEWALK REMOVAL	SQ FT	556.0		556.0	
44003800	MEDIAN SURFACE REMOVAL	SQ FT	177.0			177.0
50104605	CONCRETE RETAINING WALL REMOVAL	CU YD	2.0		2.0	
60262700	INLETS TO BE RECONSTRUCTED	EACH	1.0		1.0	
60406400	FRAMES AND LIDS, TYPE 15	EACH	1.0		1.0	
60605000	COMBINATION CONCRETE CURB AND GUTTER, TYPE B-6.24	FOOT	40.0			40.0
60607900	COMBINATION CONCRETE CURB AND GUTTER, TYPE B-9.24 (VARIABLE WIDTH GUTTER FLAG)	FOOT	107.0			107.0
60608600	COMBINATION CONCRETE CURB AND GUTTER, TYPE M-6.06	FOOT	28.0			28.0

SUMMARY OF QUANTITIES

URBAN
80% FED
20% STATE

Y031-1F

SFTY-1A

A000-1A

PAYCODE	ITEM DESCRIPTION	UNIT	TOTAL QUANTITIES	TRAFFIC SIGNALS	PEDESTRIAN RAMPS	CHANNELIZATION
60609100	COMBINATION CONCRETE CURB AND GUTTER, TYPE M-6.06 (VARIABLE WIDTH GUTTER FLAG)	FOOT	10.0			10.0
60618300	CONCRETE MEDIAN SURFACE, 4 INCH	SQ FT	248.0			248.0
67100100	MOBILIZATION	L SUM	1.0	0.2	0.4	0.4
70102635	TRAFFIC CONTROL AND PROTECTION, STANDARD 701701	L SUM	1.0	0.2	0.2	0.6
70102640	TRAFFIC CONTROL AND PROTECTION, STANDARD 701801	L SUM	1.0	0.2	0.6	0.2
70300230	TEMPORARY PAVEMENT MARKING - LINE 5"	FOOT	400.0			400.0
* 78000300	THERMOPLASTIC PAVEMENT MARKING - LINE 5"	FOOT	112.0			112.0
* 78000400	THERMOPLASTIC PAVEMENT MARKING - LINE 6"	FOOT	526.0			526.0
* 78000650	THERMOPLASTIC PAVEMENT MARKING - LINE 24"	FOOT	120.0			120.0
78300100	PAVEMENT MARKING REMOVAL	SQ FT	422.0			422.0
* 81012600	CONDUIT IN TRENCH, 2" DIA., PVC	FOOT	4.0	4.0		
* 81900200	TRENCH AND BACKFILL FOR ELECTRICAL WORK	FOOT	4.0	4.0		
* 87301245	ELECTRIC CABLE IN CONDUIT, SIGNAL NO. 14 5C	FOOT	12.0	12.0		
* 87700180	STEEL MAST ARM ASSEMBLY AND POLE, 28 FT.	EACH	1.0	1.0		
* 87800400	CONCRETE FOUNDATION, TYPE E 30-INCH DIAMETER	FOOT	10.0	10.0		
* 87900200	DRILL EXISTING HANDHOLE	EACH	1.0	1.0		

*Specialty Items

Rev.

FILE NAME =	USER NAME = laughlinc1	DESIGNED -	REVISED -
or\pwork\PWIDOT\LAUGHLINRL\dms20392\tssoq.dgn		DRAWN -	REVISED -
	PLOT SCALE = 100.0000' / IN.	CHECKED -	REVISED -
	PLOT DATE = Oct-15-2008 11:18:44AM	DATE -	REVISED -

STATE OF ILLINOIS
DEPARTMENT OF TRANSPORTATION

SUMMARY OF QUANTITIES

SCALE: SHEET NO. OF SHEETS STA. TO STA.

F.A.P. RTE.	SECTION	COUNTY	TOTAL SHEETS	SHEET NO.
63	78-2(ITS-2,N,T,D)	ADAMS	16	4
FED. ROAD DIST. NO.		ILLINOIS FED. AID PROJECT		
		CONTRACT NO. 72B72		

SUMMARY OF QUANTITIES

PAYCODE	ITEM DESCRIPTION	UNIT	URBAN 80% FED 20% STATE			
			TOTAL QUANTITIES	TRAFFIC SIGNALS	PEDESTRIAN RAMPS	CHANNEL-IZATION
* 88040090	SIGNAL HEAD, POLYCARBONATE, LED, 1-FACE, 3-SECTION, MAST ARM MOUNTED	EACH	2.0	2.0		
* 88040230	SIGNAL HEAD, POLYCARBONATE, LED, 2-FACE, 3-SECTION, BRACKET MOUNTED	EACH	1.0	1.0		
* 88040330	SIGNAL HEAD, POLYCARBONATE, LED, 3-FACE, 2-3-SECTION, 1-5-SECTION, BRACKET MOUNTED	EACH	1.0	1.0		
* 88102830	PEDESTRIAN SIGNAL HEAD, POLYCARBONATE, LED, 2-FACE, BRACKET MOUNTED	EACH	2.0	2.0		
* 88200100	TRAFFIC SIGNAL BACKPLATE	EACH	3.0	3.0		
* 88800100	PEDESTRIAN PUSH-BUTTON	EACH	8.0	8.0		
* 89502350	REMOVE AND REINSTALL ELECTRIC CABLE FROM CONDUIT	FOOT	73.0	73.0		
* 89502375	REMOVE EXISTING TRAFFIC SIGNAL EQUIPMENT	EACH	1.0	1.0		
* 89502385	REMOVE EXISTING CONCRETE FOUNDATION	EACH	1.0	1.0		
* X0323153	ELECTRIC CABLE IN CONDUIT, GROUND, NO. 6 1C (GREEN)	FOOT	343.5	343.5		
* X8950200	REBUILD EXISTING HANDHOLE	EACH	2.0	2.0		
XX001244	RETAINING WALL	FOOT	17.0		17.0	
XX003313	REMOVE AND REINSTALL BRICK PAVER	SQ FT	114.0			114.0

**Specialty Items*

FILE NAME =	USER NAME = laughlinr1	DESIGNED -	REVISED -	STATE OF ILLINOIS DEPARTMENT OF TRANSPORTATION	SUMMARY OF QUANTITIES	F.A.P. RTE.	SECTION	COUNTY	TOTAL SHEETS	SHEET NO.
ea:\pwork\PHWIDOT\LAUHLINR1\dms20392\htseq.dgn	DRAWN -	REVISED -	63			78-2(ITS-2,N,T,I)	ADAMS	16	5	
PLOT SCALE = 100.0000' / IN.	CHECKED -	REVISED -	CONTRACT NO. 72B72							
PLOT DATE = Oct-15-2008 11:18:16AM	DATE -	REVISED -	SCALE:			SHEET NO.	OF SHEETS	STA.	TO STA.	FED. ROAD DIST. NO.

SUBBASE GRANULAR MAT, TY B 4"

LOCATION	STATION TO STATION		LENGTH	WIDTH	AREA
			FOOT	FOOT	SQ YD
MEDIAN ISLAND	9+00.00	9+70.29	106.8	1.08	12.8
MEDIAN ISLAND	9+84	9+84	17.3	1.58	3.0
MEDIAN ISLAND	9+87.11	9+87.11	10.5	1.58	1.8
MEDIAN ISLAND	9+86	LT	5	2	1.1
MEDIAN ISLAND	9+86	RT	5	2	1.1
NORTHEAST CORNER	10+23.21	10+31.19	14.7	3.08	5.0
SOUTHEAST CORNER	10+21.22	10+30.44	25.7	3.08	8.8
TOTAL					33.6
USE					34.0

**COMBINATION CONCRETE CURB & GUTTER TY B-9.24
(VARIABLE WIDTH GUTTER FLAG)**

LOCATION	STATION TO STATION	LENGTH
		FT
MEDIAN ISLAND	9+00.00 9+73.73	107.0
TOTAL		107.0
USE		107.0

DETECTABLE WARNINGS

STATION	OFFSET	LENGTH	WIDTH	AREA
		FT	FT	SQ FT
9+29	70 RT	5	2	10
9+55	57 RT	5	2	10
9+59	55 LT	5	2	10
9+78	37 LT	5	2	10
9+81	34 LT	5	2	10
9+81	11 LT	5	2	10
9+81	6 RT	5	2	10
9+82	36 RT	5	2	10
9+84	36 LT	5	2	10
9+86	42 RT	5	2	10
10+23	38 RT	5	2	10
10+25	38 LT	5	2	10
10+28	34 LT	5	2	10
10+28	35 RT	5	2	10
TOTAL				140
USE				140

PCC SIDEWALK 4"

LOCATION	AREA	
	SQ FT	
NORTHEAST CORNER	418.42	
SOUTHEAST CORNER	209.53	
MEDIAN ISLAND	90.68	
TOTAL		718.63
USE		719

PAVEMENT REMOVAL

STATION TO STATION	LENGTH	WIDTH	AREA
			SQ YD
	FT	FT	
9+73.76 9+87.61	13.85	20	31.31
TOTAL			31.31
USE			32

CURB REMOVAL

LOCATION	STATION TO STATION		LENGTH
			FT
MEDIAN ISLAND	9+00	9+70.29	97.0
TOTAL			97.0
USE			97

COMB. CURB & GUTTER REMOVAL

LOCATION	STATION TO STATION		LENGTH
			FT
NORTHEAST CORNER	10+23.21	10+31.19	14.8
SOUTHEAST CORNER	10+21.22	10+30.44	26.2
TOTAL			41.0
USE			41

SIDEWALK REMOVAL

LOCATION	AREA	
	SQ FT	
NORTHEAST CORNER	398.53	
SOUTHEAST CORNER	157.02	
TOTAL		555.55
USE		556

MEDIAN SURFACE REMOVAL

LOCATION	STATION TO STATION		LENGTH
			SQ FT
MEDIAN ISLAND	9+00	9+57.3	59.99
MEDIAN ISLAND	9+57.3	9+72.96	116.56
TOTAL			176.55
USE			177

REMOVE & REINSTALL BRICK PAVEMENT

LOCATION	STATION TO STATION		LENGTH
			SQ FT
MEDIAN ISLAND	9+00	9+57.3	113.58
TOTAL			113.58
USE			114

CONCRETE RETAINING WALL REMOVAL

LOCATION	STATION TO STATION		LENGTH
			FT
SOUTHEAST CORNER	10+30.98	10+45.96	22.0
TOTAL			22.0
USE			22

COMB. CONC. CURB & GUTTER TY B-6.24

LOCATION	STATION TO STATION		LENGTH
			FT
NORHEAST CORNER	10+23.21	10+31.19	14.7
SOUTHEAST CORNER	10+21.22	10+30.44	25.7
TOTAL			40.4
USE			40

COMB. CONC. CURB & GUTTER TY M-6.06

LOCATION	STATION	LENGTH
		FT
MEDIAN ISLAND	9+84.00	17.3
MEDIAN ISLAND	9+87.11	10.5
TOTAL		27.8
USE		28

COMB. CONC. CURB & GUTTER TY M-6.06 (VWG)

LOCATION	STATION	LENGTH
		FT
MEDIAN ISLAND	9+86 LT	5.0
MEDIAN ISLAND	9+86 RT	5.0
TOTAL		10.0
USE		10

CONCRETE MEDIAN SURFACE 4"

LOCATION	STATION TO STATION		AREA
			SQ FT
MEDIAN ISLAND	9+00.00	9+78.43	247.8
TOTAL			247.8
USE			248

FILE NAME =	USER NAME = laughlinr1	DESIGNED -	REVISED -
et:\pwork\pwork\LAUGHLINRL\dms20392\tsch.dgn		DRAWN -	REVISED -
		CHECKED -	REVISED -
		DATE -	REVISED -

**STATE OF ILLINOIS
DEPARTMENT OF TRANSPORTATION**

SCHEDULE OF QUANTITIES

SCALE:	SHEET NO.	OF	SHEETS	STA.	TO	STA.
--------	-----------	----	--------	------	----	------

F.A.P. RTE.	SECTION	COUNTY	TOTAL SHEETS	SHEET NO.
63	78-2(TS-2,N,T,I)	ADAMS	16	6
CONTRACT NO. 72B72				
FED. ROAD DIST. NO. ILLINOIS FED. AID PROJECT				

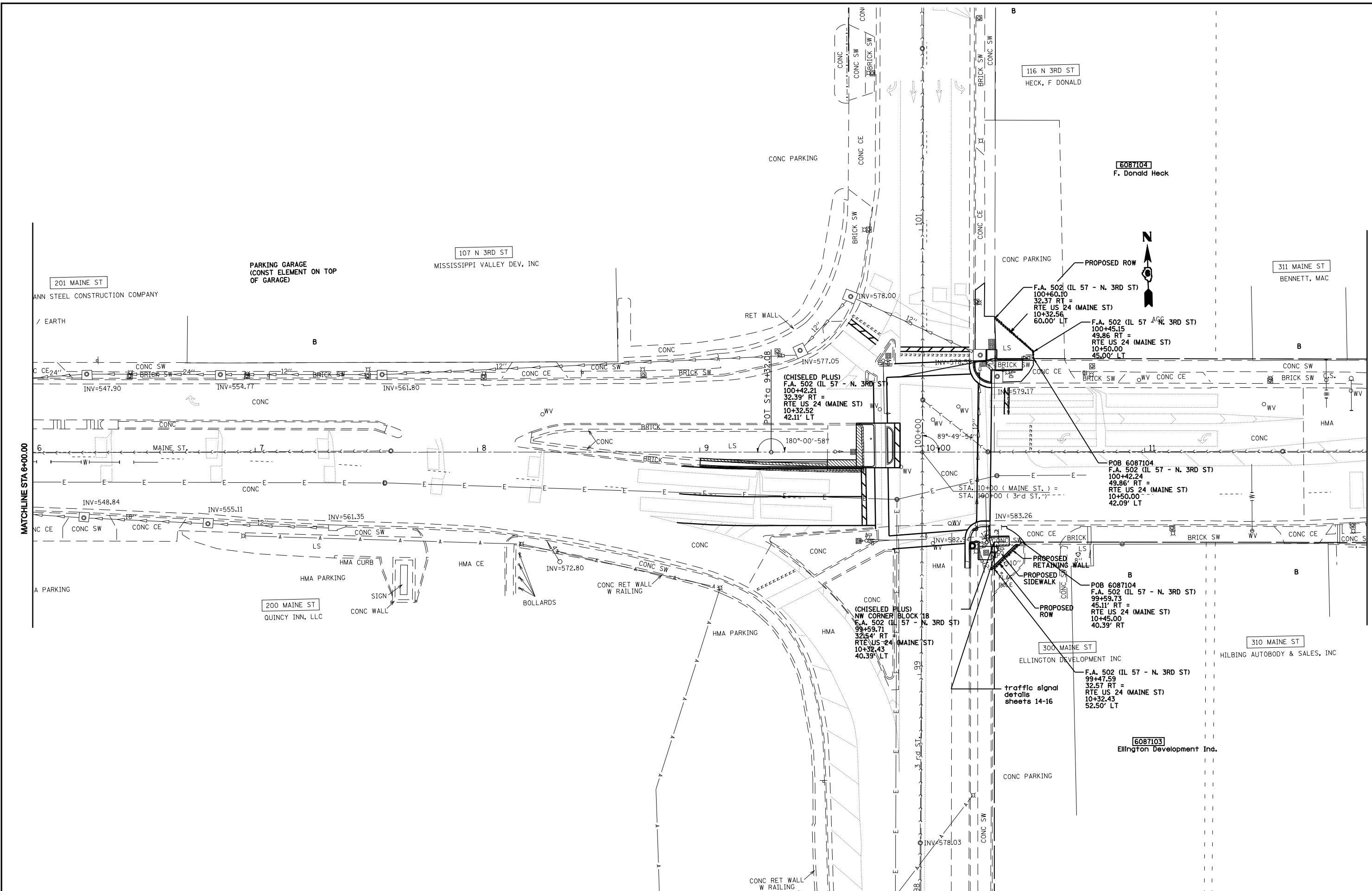

FILE NAME =	USER NAME = laughlinr1	DESIGNED -	REVISED -	STATE OF ILLINOIS DEPARTMENT OF TRANSPORTATION	3rd St Quincy			F.A.P. RTE.	SECTION	COUNTY	TOTAL SHEETS	SHEET NO.
et:\pw\work\PWIDOT\LAUGHLINRL\dms20392\h1plan.dgn		DRAWN -	REVISED -		63	78-2(ITS-2,N,T,I)	ADAMS	16	7			
PLOT SCALE = 40.0000' / IN.		CHECKED -	REVISED -		CONTRACT NO. 72B72							
PLOT DATE = Oct-10-2008 09:53:59AM		DATE -	REVISED -		FED. ROAD DIST. NO. ILLINOIS FED. AID PROJECT							
					SCALE:	SHEET NO.	OF SHEETS	STA.	TO STA.			

ST
 EY DEV, INC

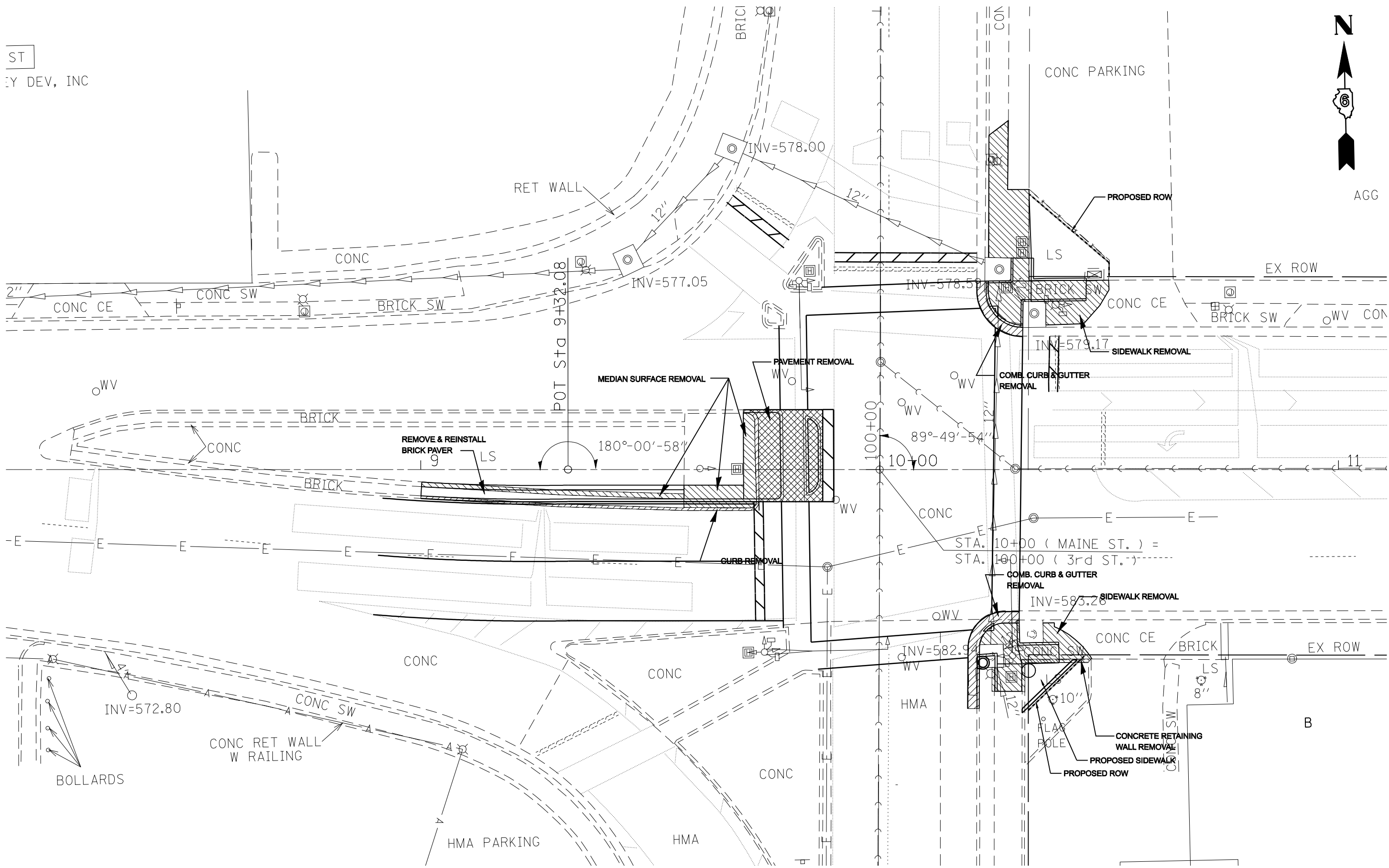

FILE NAME =	USER NAME = laughlinr1	DESIGNED -	REVISED -
et:\pwork\pwork\LAUGHLINRL\dms20392\entrem_plan.dgn		DRAWN -	REVISED -
	PLOT SCALE = 20.0000' / IN.	CHECKED -	REVISED -
	PLOT DATE = Oct-10-2008 09:54:02AM	DATE -	REVISED -

**STATE OF ILLINOIS
 DEPARTMENT OF TRANSPORTATION**

REMOVAL PLAN				
SCALE:	SHEET NO.	OF SHEETS	STA.	TO STA.

F.A.P. RTE.	SECTION	COUNTY	TOTAL SHEETS	SHEET NO.
63	78-2(ITS-2,N,T,I)	ADAMS	16	8
FED. ROAD DIST. NO. ILLINOIS FED. AID PROJECT			CONTRACT NO. 72B72	

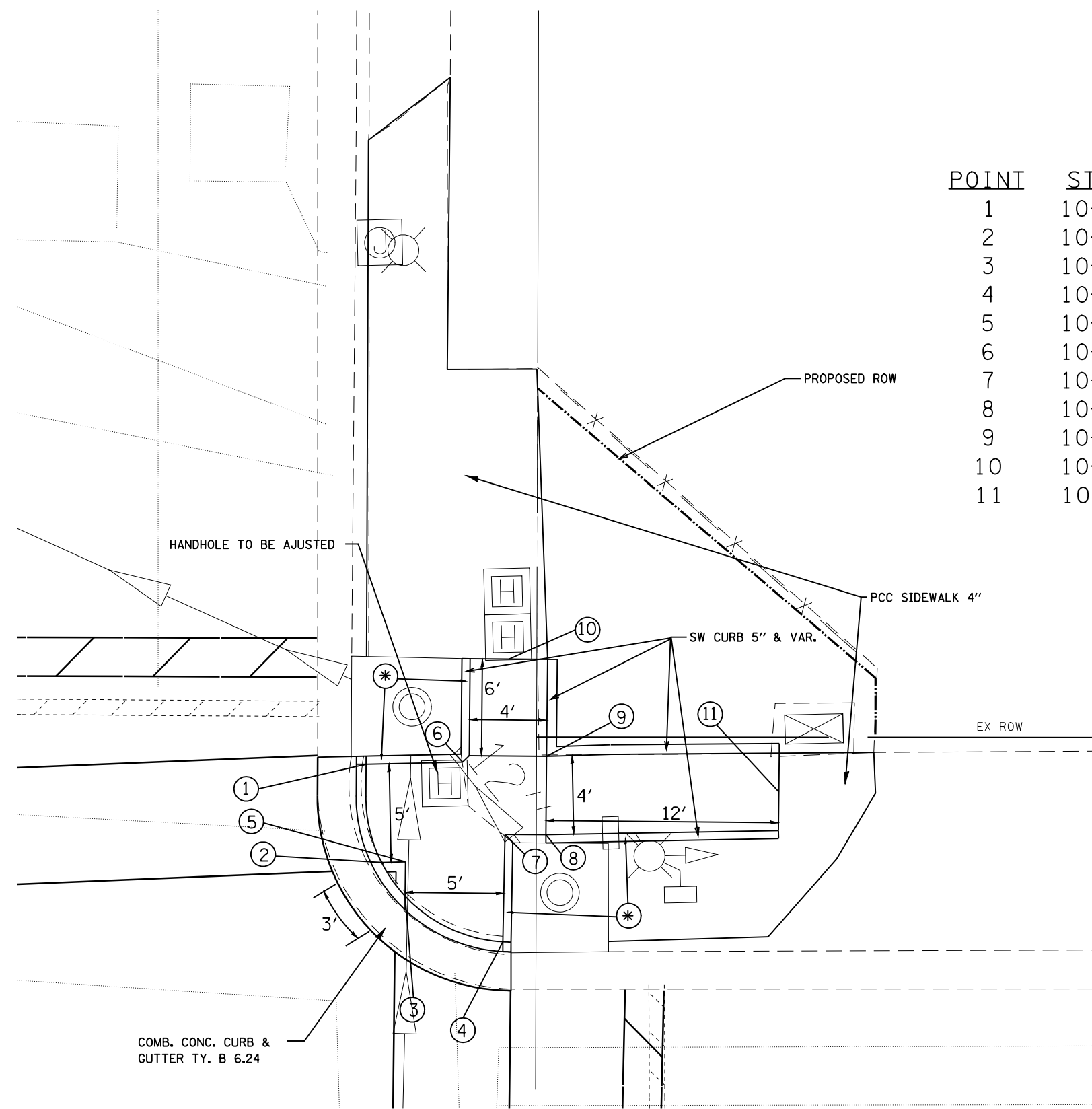

POINT	STATION	OFFSET (LT)	ELEVATION
1	10+23.70	40.70	585.79
2	10+24.50	35.63	586.02
3	10+25.73	33.89	586.11
4	10+30.77	31.53	586.31
5	10+25.75	35.66	586.08
6	10+28.68	40.80	586.27
7	10+30.87	37.07	586.33
8	10+32.99	37.05	586.35
9	10+33.03	41.10	586.35
10	10+31.07	46.12	586.73
11	10+45.01	39.27	587.35

* CURB ACCORDING TO STANDARD 424001 TYPE A EXCEPT CURB WIDTH SHALL BE 5" & VAR.

FILE NAME =	USER NAME = laughlinr1	DESIGNED -	REVISED -	STATE OF ILLINOIS DEPARTMENT OF TRANSPORTATION	NE QUADRANT DETAILS				F.A.P. RTE.	SECTION	COUNTY	TOTAL SHEETS	SHEET NO.
et:\pwork\pwork\LAUGHLINRL\dms20392\hst\deta1.dgn		DRAWN -	REVISED -		63	78-2(ITS-2,N,T,I)	ADAMS	16	9				
PLOT SCALE = 40.0000' / IN.		CHECKED -	REVISED -		SCALE: SHEET NO. OF SHEETS STA. TO STA.				CONTRACT NO. 72B72				
PLOT DATE = Oct-10-2008 09:54:04AM		DATE -	REVISED -		FED. ROAD DIST. NO. ILLINOIS FED. AID PROJECT								

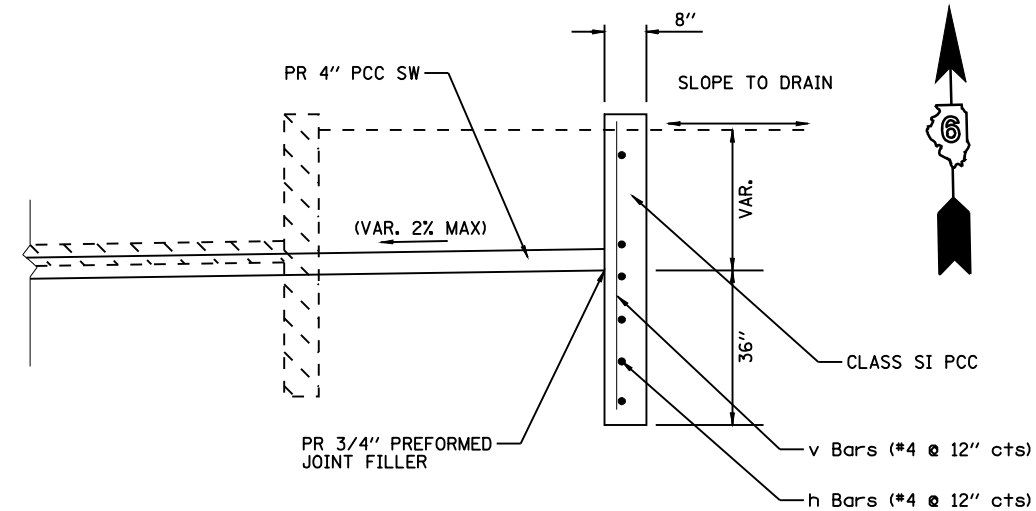
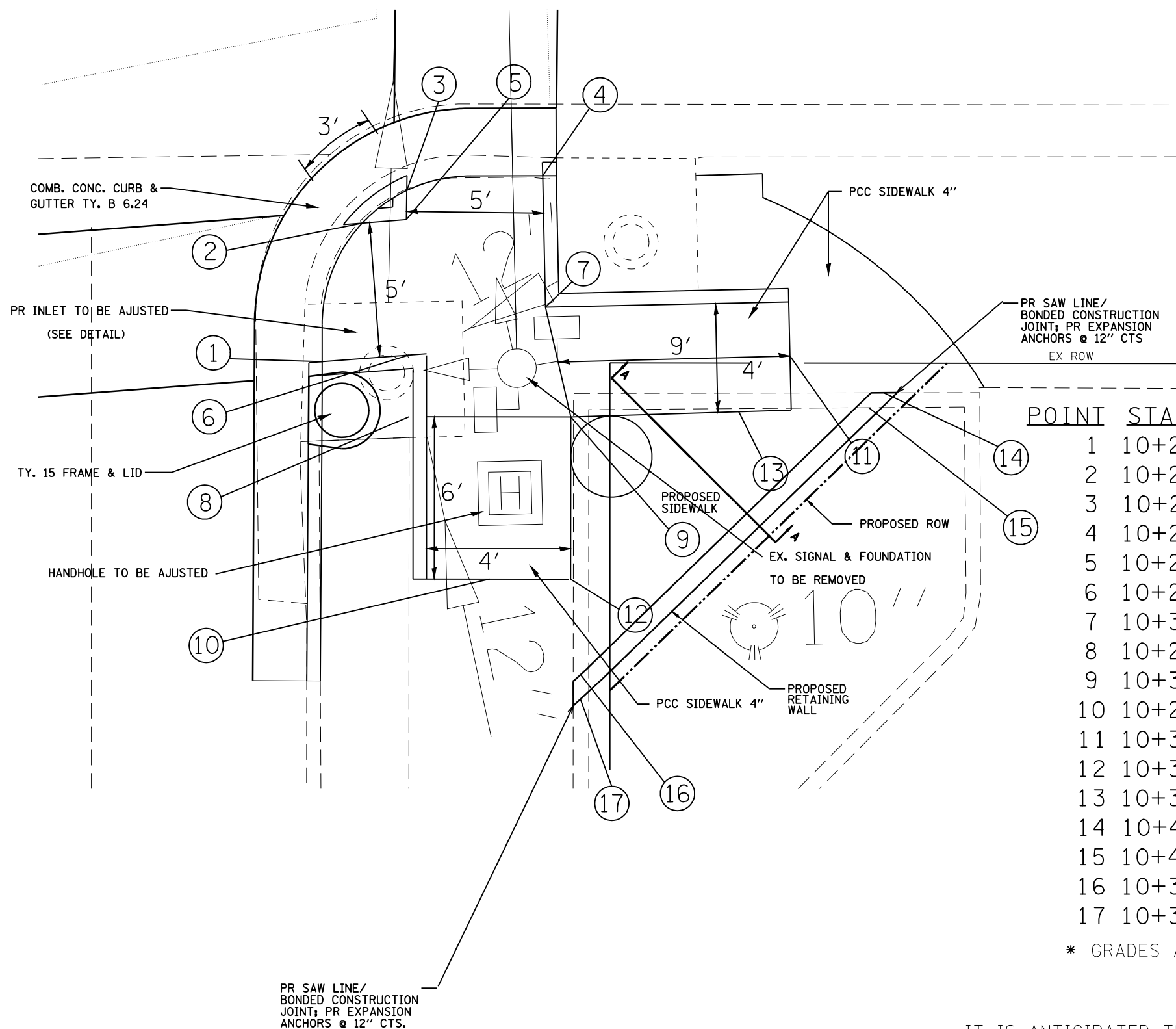

SECTION A-A
(PR RETAINING WALL)

POINT	STATION	OFFSET (RT)	ELEV	
1	10+21.78	40.35	585.74	
2	10+23.27	35.22	585.85	
3	10+24.91	34.01	585.91	
4	10+29.94	33.47	586.04	
5	10+24.90	35.09	585.91	
6	10+25.00	40.10	586.00	
7	10+30.05	38.33	586.06	
8	10+25.00	42.38	586.06	
9	10+30.98	42.39	586.14	
10	10+27.99	48.38	586.60 *	
11	10+39.09	40.13	586.85	
12	10+30.98	48.39	586.72 *	
13	10+37.20	42.19	586.73	
14	10+45.41	41.94	587.69 *	-TOP OF WALL
15	10+42.00	42.04	587.75	-TOP OF WALL
16	10+31.32	51.91	588.47	-TOP OF WALL
17	10+31.32	52.81	588.54	-TOP OF WALL

* GRADES ARE TO BE ADJUSTED TO MATCH FIELD CONDITIONS

NOTE

IT IS ANTICIPATED THAT ADDITIONAL CONCRETE WILL BE NEEDED TO POUR THE SIDEWALK OVER THE ADJUSTED INLET LID. THIS COST SHALL BE INCLUDED IN THE COST OF THE SIDEWALK AND NO ADDITIONAL COMPENSATION WILL BE ALLOWED.

FILE NAME =	USER NAME = laughlinr1	DESIGNED -	REVISED -	STATE OF ILLINOIS DEPARTMENT OF TRANSPORTATION	SE QUADRANT DETAILS				F.A.P. RTE.	SECTION	COUNTY	TOTAL SHEETS	SHEET NO.
et:\pw\work\PWIDOT\LAUGHLINRL\dms20392\hst\deta1.dgn	DRAWN -	REVISED -	REVISED -						63	78-2(ITS-2,N,T,I)	ADAMS	16	10
PLOT SCALE = 40.0000' / IN.	CHECKED -	REVISED -	REVISED -		CONTRACT NO. 72B72								
PLOT DATE = Oct-10-2008 09:54:06AM	DATE -	REVISED -	REVISED -		FED. ROAD DIST. NO.	ILLINOIS	FED. AID PROJECT						

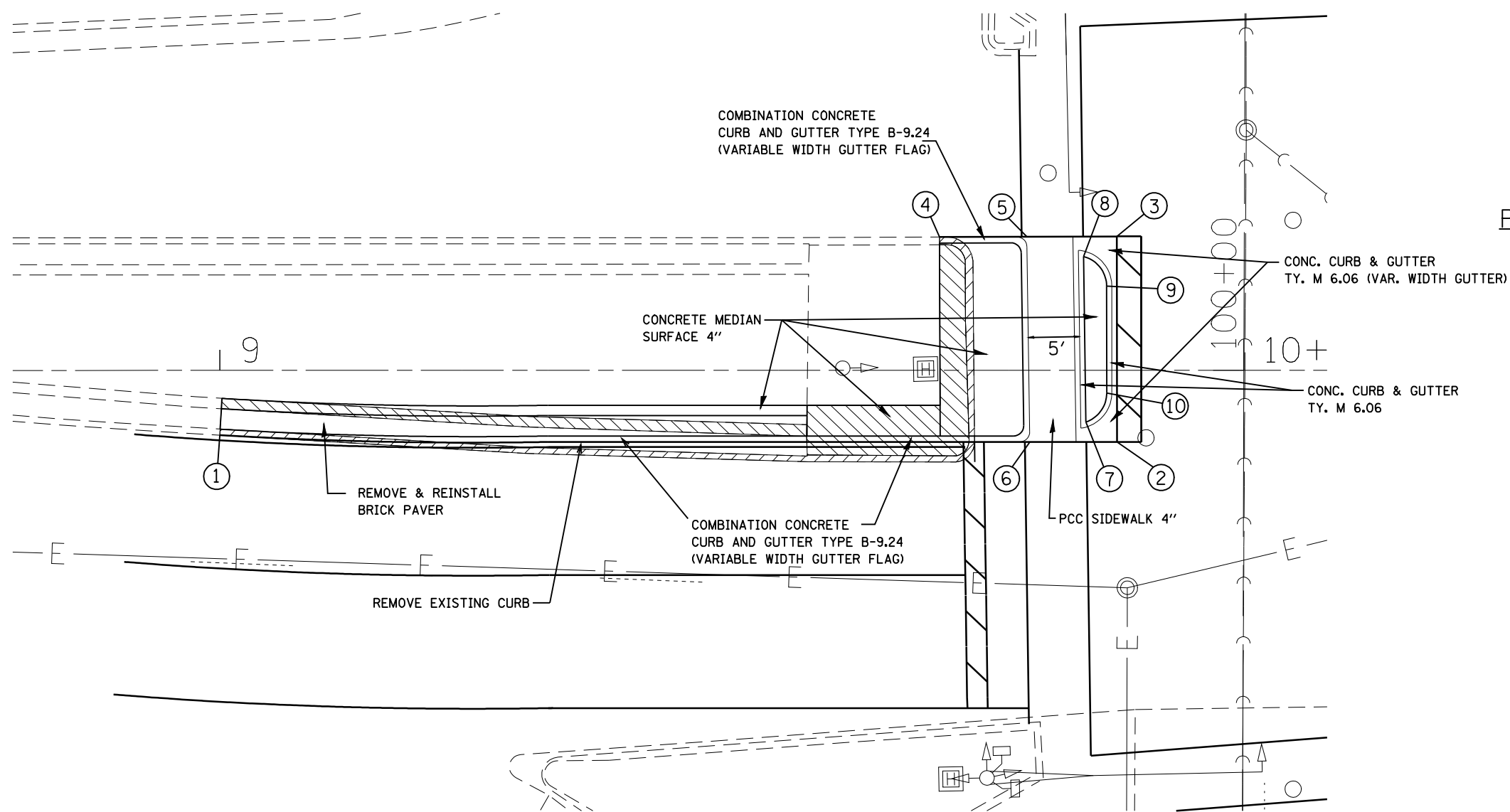

POINT	STATION	OFFSET	LT / RT
1	9+00.00	6.32	RT
2	9+87.61	7.00	RT
3	9+87.59	13.08	LT
4	9+70.29	13.01	LT
5	9+78.82	13.04	LT
6	9+79.11	7.00	RT
7	9+84.58	5.05	RT
8	9+84.34	11.12	LT
9	9+86.61	8.22	LT
10	9+86.62	2.23	RT

NOTE

THE EXISTING PAVEMENT WILL BE THE CONTROLLING FACTOR IN DETERMINING THE GRADES AT EACH POINT.

FILE NAME =	USER NAME = laughlinr1	DESIGNED -	REVISED -
et:\pw\work\PWIDOT\LAUGHLINRL\dms20392\cmtdetail.dgn		DRAWN -	REVISED -
	PLOT SCALE = 40.0000' / IN.	CHECKED -	REVISED -
	PLOT DATE = Oct-10-2008 09:54:09AM	DATE -	REVISED -

**STATE OF ILLINOIS
DEPARTMENT OF TRANSPORTATION**

CENTER MEDIAN DETAILS

SCALE: SHEET NO. OF SHEETS STA. TO STA.

F.A.P. RTE.	SECTION	COUNTY	TOTAL SHEETS	SHEET NO.
63	78-2(ITS-2,N,T,I)	ADAMS	16	11
CONTRACT NO. 72B72				
FED. ROAD DIST. NO. ILLINOIS FED. AID PROJECT				

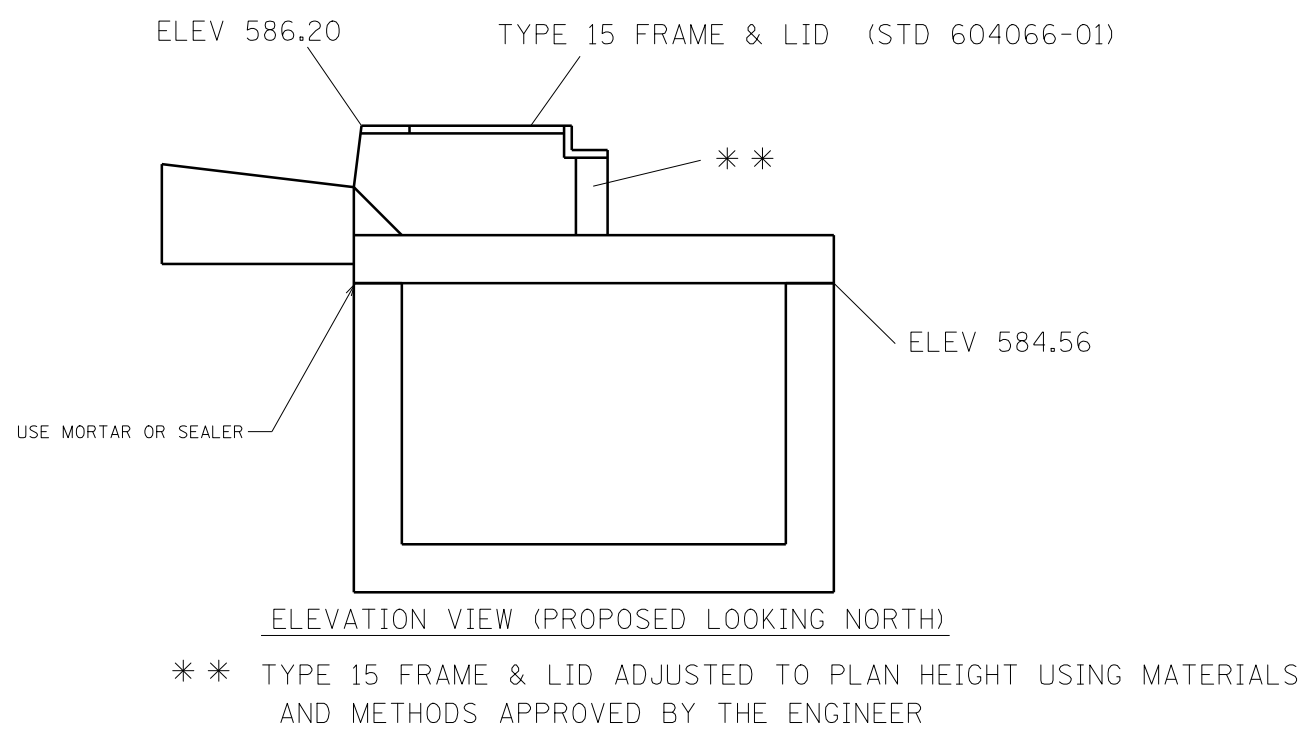
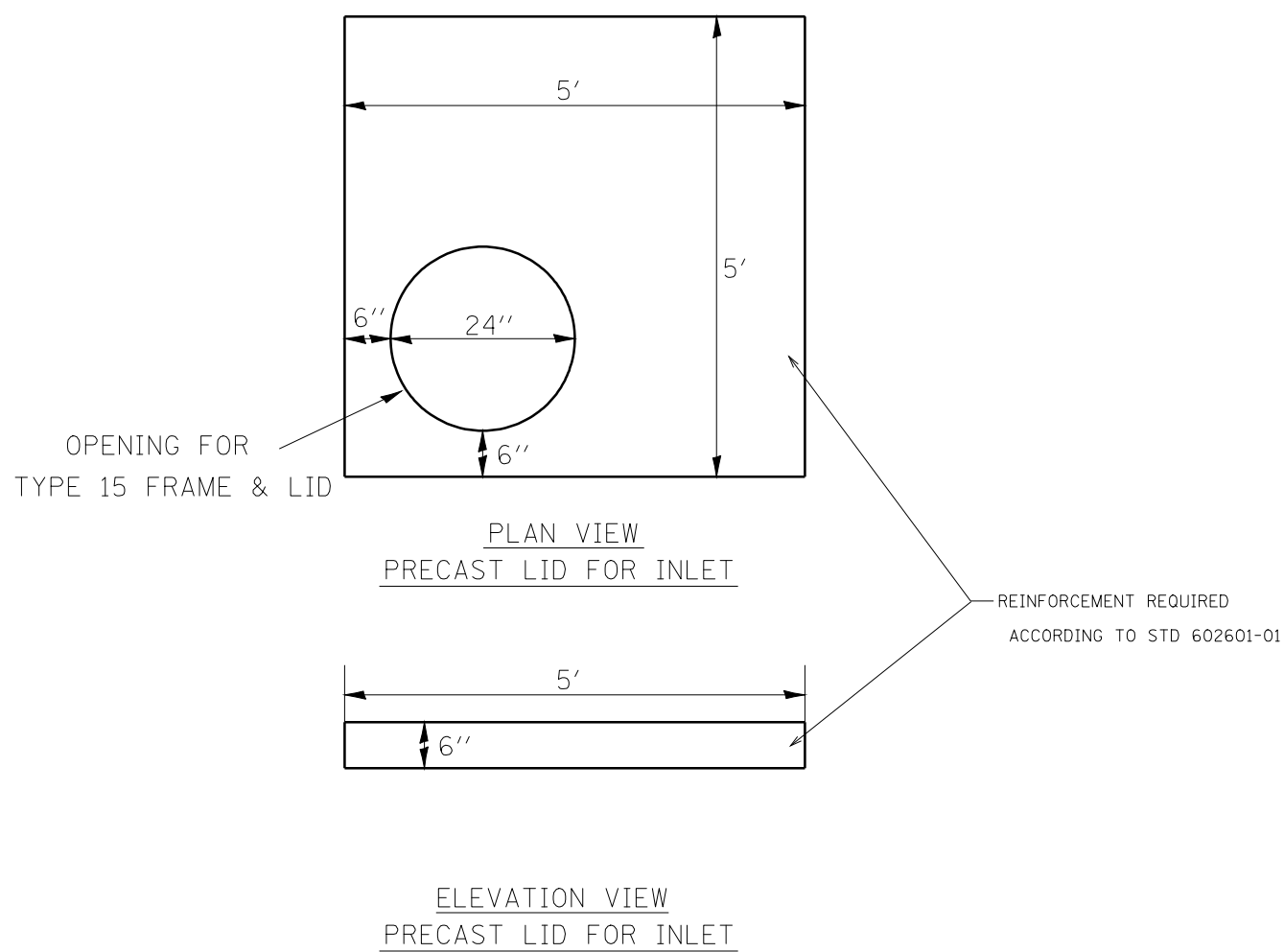
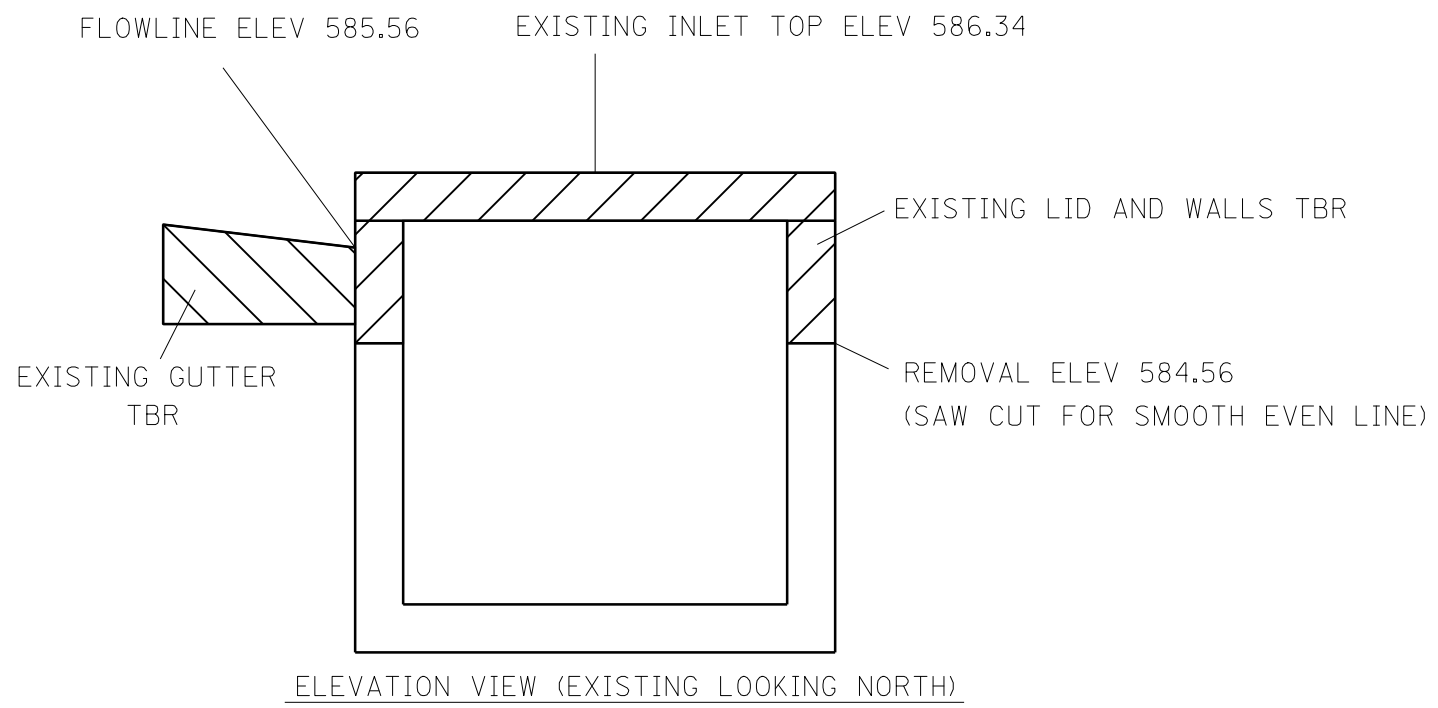

- NOTES
- CONTRACTOR SHALL FIELD VERIFY DIMENSION FOR THE PRECAST LID BEFORE ORDERING IT.
 - CURB & GUTTER SHALL BE BUILT TO APPLICABLE PORTIONS OF STANDARDS 606001 & 604066

FILE NAME =	USER NAME = laughlinr1	DESIGNED -	REVISED -	STATE OF ILLINOIS DEPARTMENT OF TRANSPORTATION	INLET SPECIAL DETAILS				F.A.P. RTE.	SECTION	COUNTY	TOTAL SHEETS	SHEET NO.
et:\pw\work\PWIDOT\LAUGHLINRL\dms20392\inletdetail.dgn		DRAWN -	REVISED -		63	78-2(ITS-2,N,T,I)	ADAMS	16	12				
PLOT SCALE = 40.0000' / IN.		CHECKED -	REVISED -		SCALE: SHEET NO. OF SHEETS STA. TO STA.				CONTRACT NO. 72B72				
PLOT DATE = Oct-10-2008 09:54:11AM		DATE -	REVISED -		FED. ROAD DIST. NO. ILLINOIS FED. AID PROJECT								

- ① THERMOPLASTIC PAVEMENT MARKING LINE 6" WHITE
- ② THERMOPLASTIC PAVEMENT MARKING LINE 5" YELLOW
- ③ THERMOPLASTIC PAVEMENT MARKING LINE 24" WHITE
- ④ PAVEMENT MARKING REMOVAL

ST
EY DEV, INC

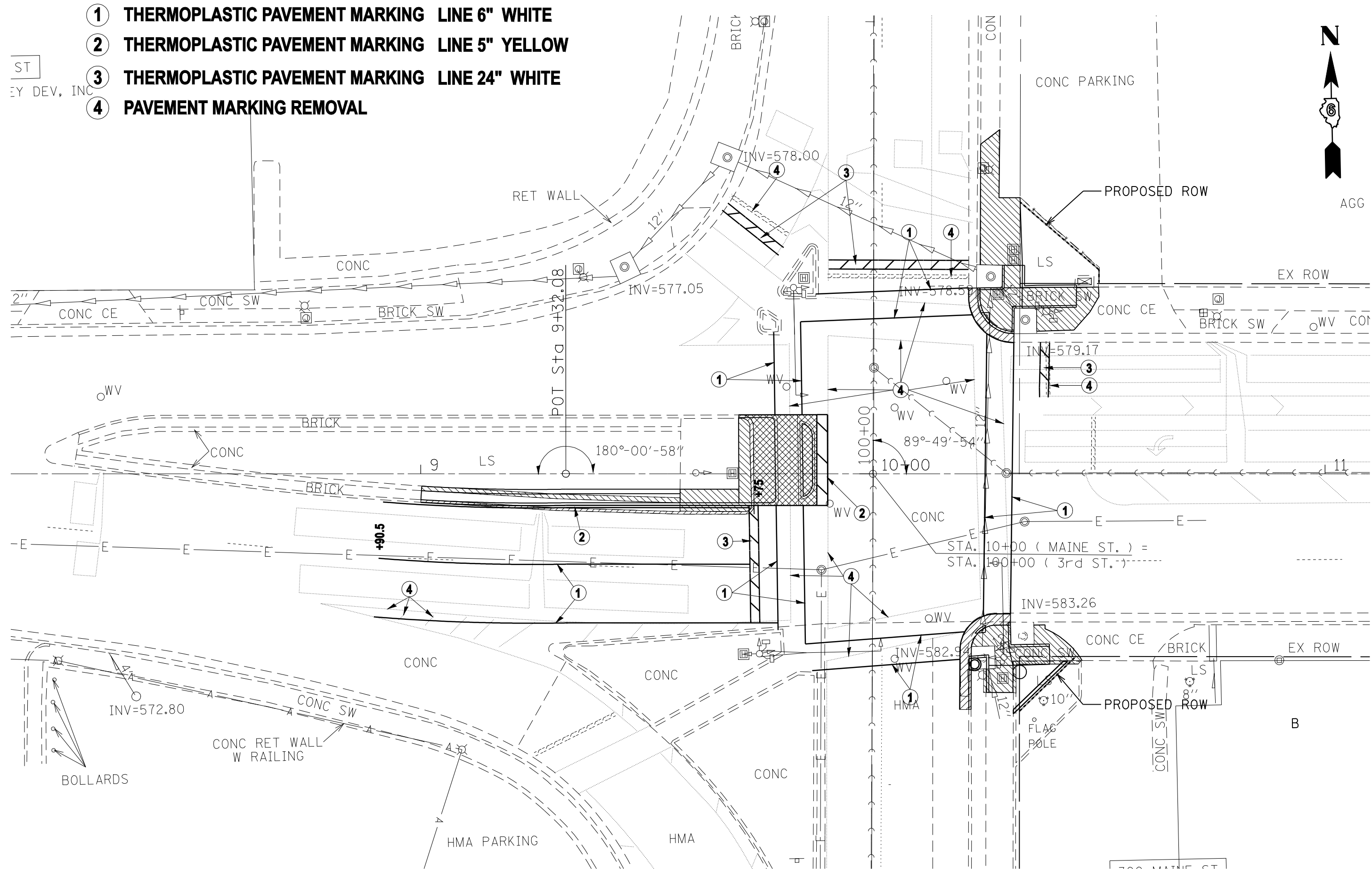

FILE NAME =	USER NAME = laughlinr1	DESIGNED -	REVISED -
et:\pwork\pwork\LAUGHLINRL\dms20392\pvtmarking_plan.dgn		DRAWN -	REVISED -
PLOT SCALE = 20.0000' / IN.		CHECKED -	REVISED -
PLOT DATE = Oct-10-2008 09:54:13AM		DATE -	REVISED -

**STATE OF ILLINOIS
DEPARTMENT OF TRANSPORTATION**

PAVEMENT MARKING PLAN

SCALE: SHEET NO. OF SHEETS STA. TO STA.

F.A.P. RTE.	SECTION	COUNTY	TOTAL SHEETS	SHEET NO.
63	78-2(ITS-2,N,T,I)	ADAMS	16	13
CONTRACT NO. 72B72				
FED. ROAD DIST. NO. ILLINOIS FED. AID PROJECT				

TRAFFIC SIGNAL QUANTITIES

LOCATION: 3RD & MAINE

QUANTITY	UNIT	ITEM
4.0	FOOT	CONDUIT IN TRENCH, 2" DIA., PVC
4.0	FOOT	TRENCH AND BACKFILL FOR ELECTRICAL WORK
12.0	FOOT	ELECTRIC CABLE IN CONDUIT, SIGNAL, NO. 14, 5/C
1	EACH	STEEL MAST ARM ASSEMBLY AND POLE, 28 FT.
10.0	FOOT	CONCRETE FOUNDATION, TYPE E, 30" DIA.
1	EACH	DRILL EXISTING HANDHOLE
2	EACH	SIGNAL HEAD, POLYCARBONATE, LED, 1-FACE, 3-SECTION, MAST ARM MOUNTED
1	EACH	SIGNAL HEAD, POLYCARBONATE, LED, 2-FACE, 3-SECTION, BRACKET MOUNTED
1	EACH	SIGNAL HEAD, POLYCARBONATE, LED, 3-FACE, 2-3 SECTION, 1-5 SECTION, BRACKET MOUNTED
2	EACH	PEDESTRIAN SIGNAL HEAD, POLYCARBONATE, LED, 2-FACE, BRACKET MOUNTED
3	EACH	TRAFFIC SIGNAL BACKPLATE
8	EACH	PEDESTRIAN PUSHBUTTON
73.0	FOOT	REMOVE AND REINSTALL ELECTRIC CABLE FROM CONDUIT
1	EACH	REMOVE EXISTING TRAFFIC SIGNAL EQUIPMENT
1	EACH	REMOVE EXISTING CONCRETE FOUNDATION
343.5	FOOT	ELECTRIC CABLE IN CONDUIT, GROUND, NO. 6 1/C (GREEN)
2	EACH	REBUILD EXISTING HANDHOLE

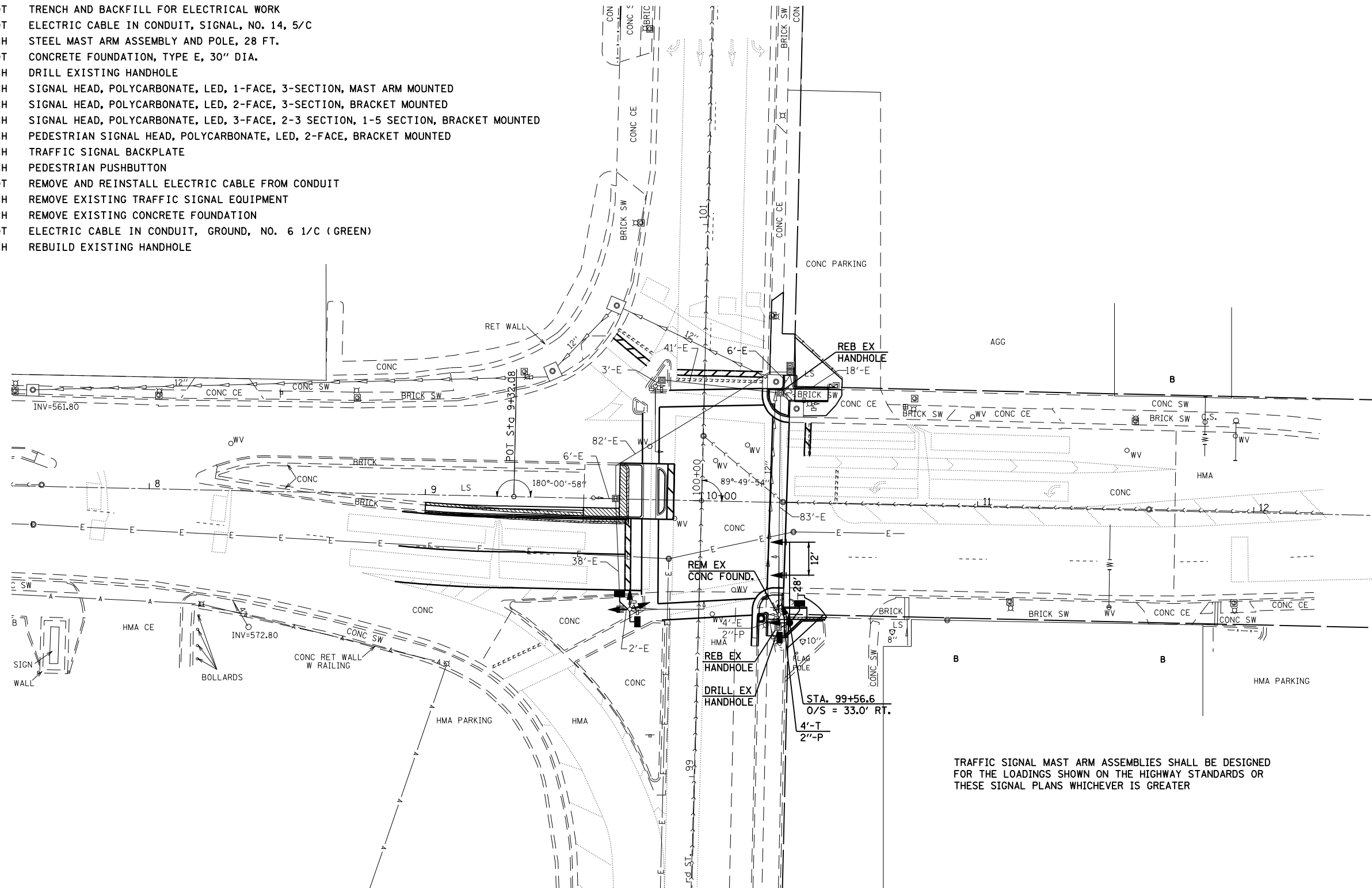

TRAFFIC SIGNAL MAST ARM ASSEMBLIES SHALL BE DESIGNED FOR THE LOADINGS SHOWN ON THE HIGHWAY STANDARDS OR THESE SIGNAL PLANS WHICHEVER IS GREATER

FILE NAME =	USER NAME = laughlinr1	DESIGNED -	REVISED -	STATE OF ILLINOIS DEPARTMENT OF TRANSPORTATION	TRAFFIC SIGNAL DETAILS			F.A.P. RTE.	SECTION	COUNTY	TOTAL SHEETS	SHEET NO.
et:\pw\work\PWIDOT\LAUGHLINRL\dms20392\esignal.dgn		DRAWN -	REVISED -		63	78-2(TS-2,N,T,I)	ADAMS	16	14			
PLOT SCALE = 40.0000' / IN.		CHECKED -	REVISED -		CONTRACT NO. 72B72							
PLOT DATE = Oct-10-2008 09:54:16AM		DATE -	REVISED -		FED. ROAD DIST. NO.	ILLINOIS	FED. AID PROJECT					
				SCALE:	SHEET NO.	OF SHEETS	STA.	TO STA.				

EXISTING TRAFFIC SIGNAL EQUIPMENT TO BE REMOVED

- 1 EACH MAST ARM
- 3 EACH SIGNAL HEAD
- 2 EACH PEDESTRIAN SIGNAL HEAD
- 8 EACH PEDESTRIAN PUSHBUTTON

REMOVED TRAFFIC SIGNAL EQUIPMENT SHALL BE RETURNED TO THE CITY OF QUINCY

EXIST CONTROLLER

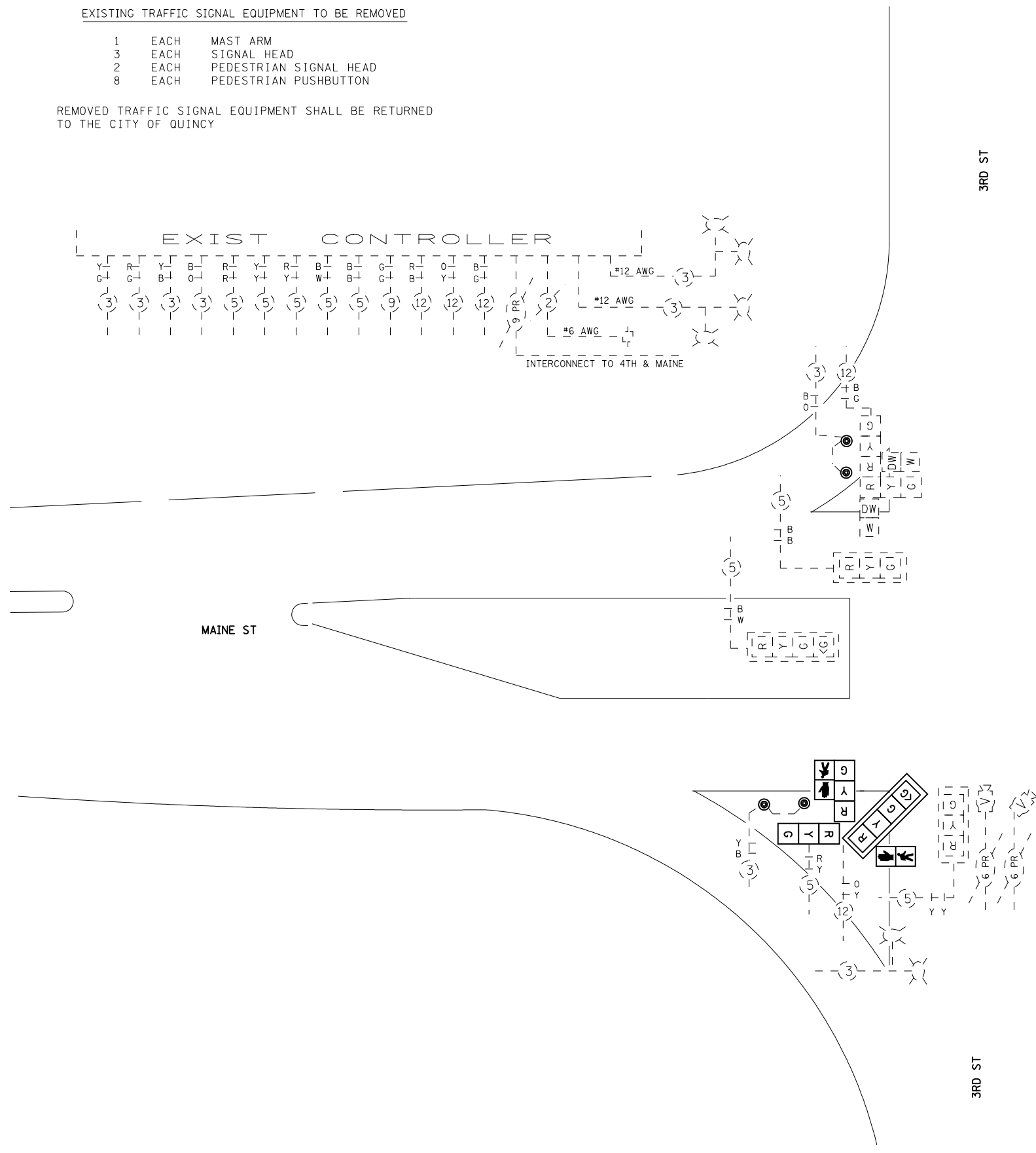
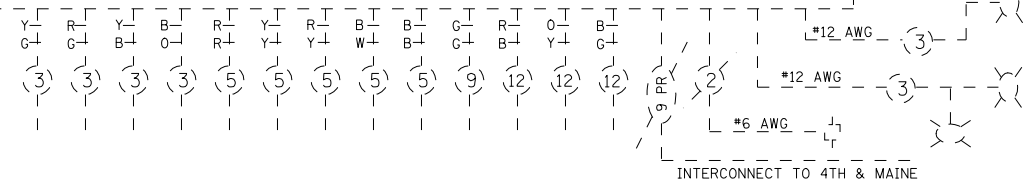

PHASE DESIGNATION DIAGRAM

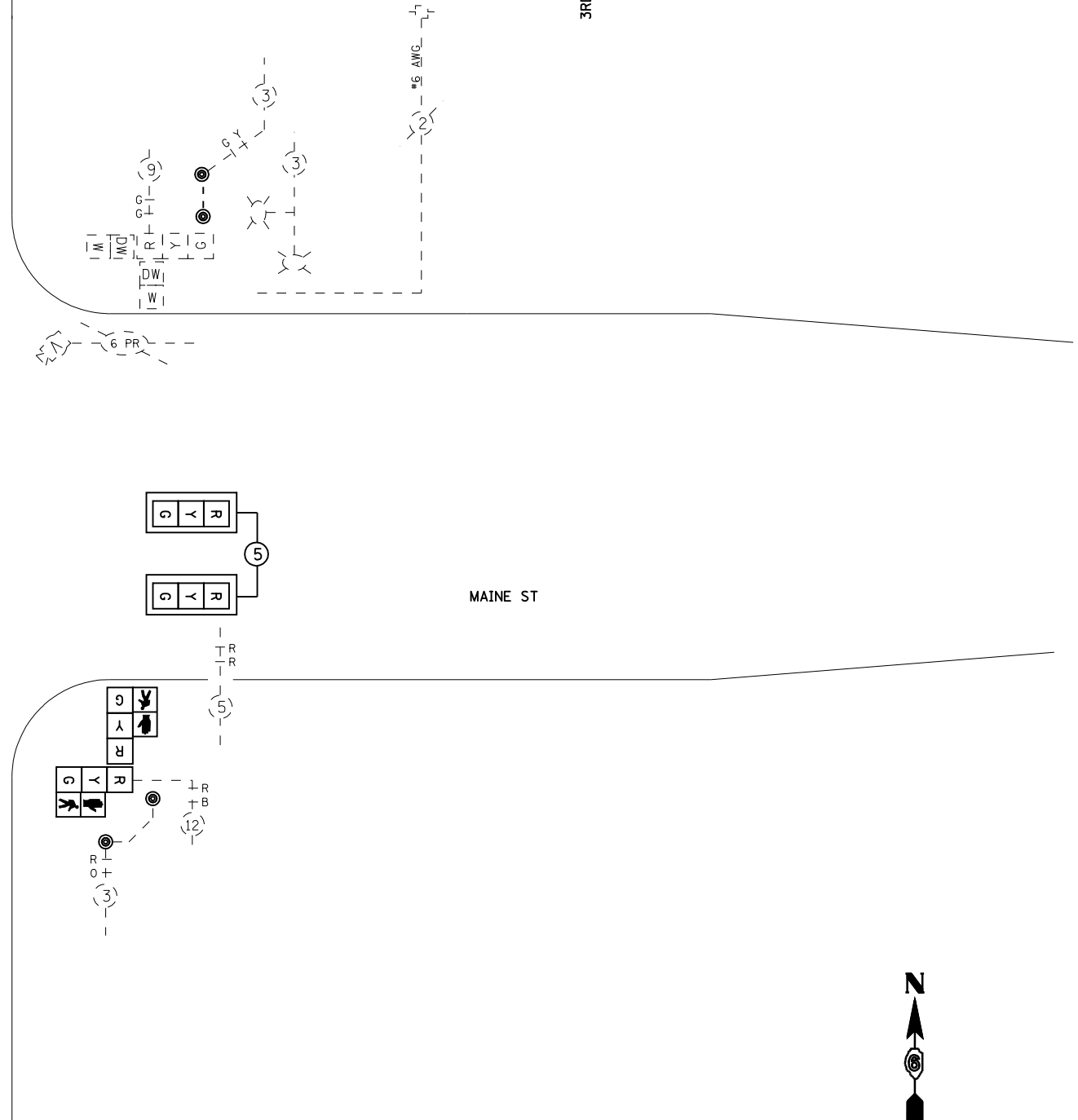
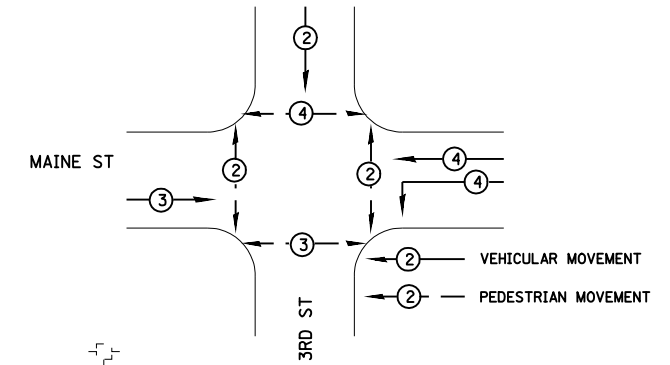

FILE NAME =	USER NAME = laughlinr1	DESIGNED -	REVISED -
et:\pw\work\PWIDOT\LAUGHLINRL\dms20392\signal.dgn		DRAWN -	REVISED -
	PLOT SCALE = 40.0000' / IN.	CHECKED -	REVISED -
	PLOT DATE = Oct-10-2008 09:54:19AM	DATE -	REVISED -

**STATE OF ILLINOIS
DEPARTMENT OF TRANSPORTATION**

TRAFFIC SIGNAL DETAILS			
SCALE:	SHEET NO.	OF SHEETS	STA. TO STA.

F.A.P. RTE.	SECTION	COUNTY	TOTAL SHEETS	SHEET NO.
63	78-2(ITS-2,N,T,I)	ADAMS	16	15
CONTRACT NO. 72B72				
FED. ROAD DIST. NO. ILLINOIS FED. AID PROJECT				

TRAFFIC SIGNAL PLAN LEGEND

EXISTING	PROPOSED	DESCRIPTION
		SIGNAL HEAD
		SIGNAL HEAD WITH BACKPLATE
		TEMPORARY SIGNAL HEAD
		PEDESTRIAN SIGNAL HEAD
		PEDESTRIAN PUSHBUTTON DETECTOR
		DETECTOR LOOP
		QUADRAPOLE DETECTOR LOOP
		SIGNAL POST
		ALUMINUM MAST ARM ASSEMBLY AND POLE
		STEEL MAST ARM ASSEMBLY AND POLE
		WOOD POLE
		WOOD POLE WITH GUY
		SERVICE INSTALLATION
		CONTROLLER
		HANDHOLE
		HEAVY DUTY HANDHOLE
		DOUBLE HANDHOLE
		JUNCTION BOX
		GULFBOX JUNCTION
		AERIAL CABLE
		CONDUIT LENGTH - CONSTRUCTION (T=TRENCH P=PUSHED A=AUGERED E=EXISTING) SIZE - TYPE (S=STEEL P=PVC F=FIBER DUCT U=UNI-DUCT)
		CONDUIT SPLICE
		SPAN WIRE / TETHER WIRE
		21 SIDEWALK REMOVAL IN SQ M (SQ FT)
		9 PC CONC SDWLK 100 mm IN SQ M (SQ YD)
		12 PC CONC SDWLK 100 mm SPECIAL IN SQ M (SQ YD)

TRAFFIC SIGNAL WIRING DIAGRAM LEGEND

EXISTING	PROPOSED	DESCRIPTION
		200 mm (8") SIGNAL SECTION
		300 mm (12") SIGNAL SECTION
		DIRECTIONAL SIGNAL SECTION
		225 mm (9") PEDESTRIAN SIGNAL FACE
		300 mm (12") PEDESTRIAN SIGNAL FACE
		SIGNAL FACE WITH BACKPLATE
		PROGRAMMED SIGNAL SECTION
		SIGNAL SECTION WITH LOUVRE
		DUAL-INDICATION SIGNAL SECTION
		INDUCTION DETECTOR LOOP
		QUADRAPOLE DETECTOR LOOP
		DIRECT-CONNECTED LOOP LEAD-IN (TWISTED)
		ELECTRIC CABLE DENOTING NUMBER OF CONDUCTORS
		ELECTRIC CABLE TO BE REMOVED
		ELECTRIC CABLE IDENTIFIER TAPE CODES (R= RED W= WHITE Y= YELLOW G= GREEN B= BLUE O= ORANGE)
		PEDESTRIAN PUSHBUTTON DETECTOR
		VIDEO DETECTION CAMERA
		EMERGENCY VEHICLE PREEMPTOR

