

ROUTE NO.	SECTION	COUNTY	SHEETS	SHEET	SHEET NO.
FAS 253 (IL 251)	68 BR-1	MARSHALL	97	76	15 SHEETS
FED. ROAD DIST. NO.		ALLIANCE	FED. AID PROJECT		

Contract #68573

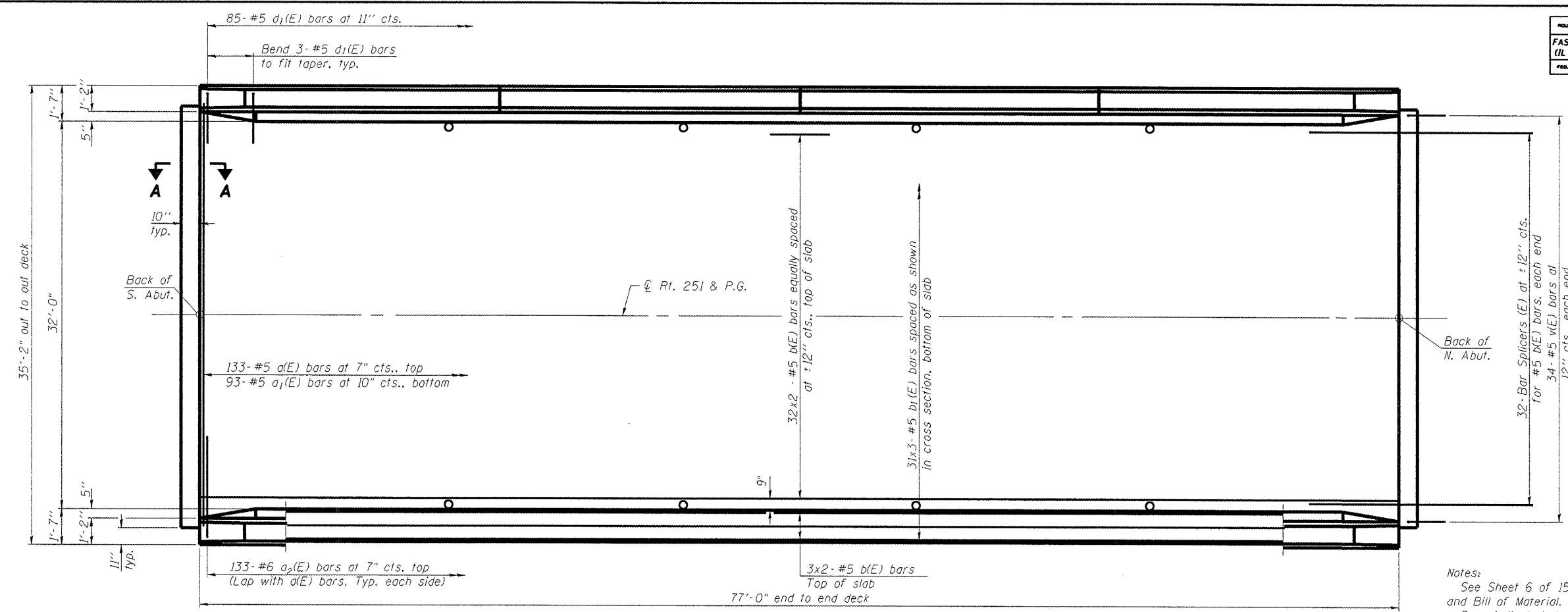

**PLAN**

Notes:  
 See Sheet 6 of 15 for superstructure details and Bill of Material.  
 Bars indicated thus 20 x 3-#5 etc. indicates 20 lines of bars with 3 lengths per line.  
 See Sheet 6 of 15 for parapet reinforcement.  
 Min. bar lap for #5 = 2'-2".

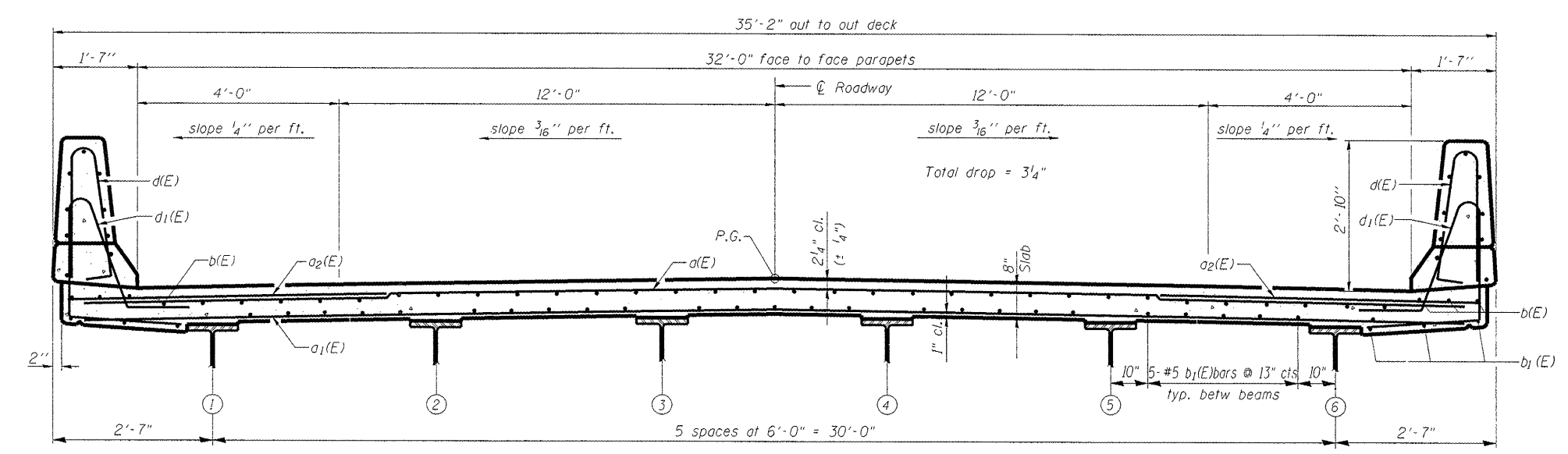

**CROSS SECTION**  
(Looking North)

**S D I** STRUCTURE DESIGNS, INCORPORATED  
 ARCHITECTS & ENGINEERS  
 PH: (773) 838-1780 • www.structuredesignsinc.com

REVISIONS	
NAME	DATE

**ILLINOIS DEPARTMENT OF TRANSPORTATION**  
**SUPERSTRUCTURE PLAN & CROSS SECTION**  
 ILL. RTE. 251  
 OVER SANDY CREEK  
 F.A.S. 253 SEC. 68 BR-1  
 MARSHALL COUNTY  
 STA. 133+80.00 S.N. 062-0085  
 DESIGNED BY: S.G. DRAWN BY: T.C.S.  
 DATE: 11-20-08 CHECKED BY: O.A.O.

SI-1-0 9-3-07