



**PROJECT BEGINS
STA. 913 + 40**

STA 918+00 NB
24"X54' RCCP WITH
INLET BOX EACH END
CLEAN CULV AND NB INLET BOX
MEDIAN-INLETS TO BE ADJUSTED (SPECIAL)

FENCE REPAIR - 25'
STA 915±00 TO STA 915±25

PLAN	BY	DATE
NO.		
NO.		
NO.		
NO.		

PROFILE	BY	DATE
NO.		
NO.		
NO.		
NO.		

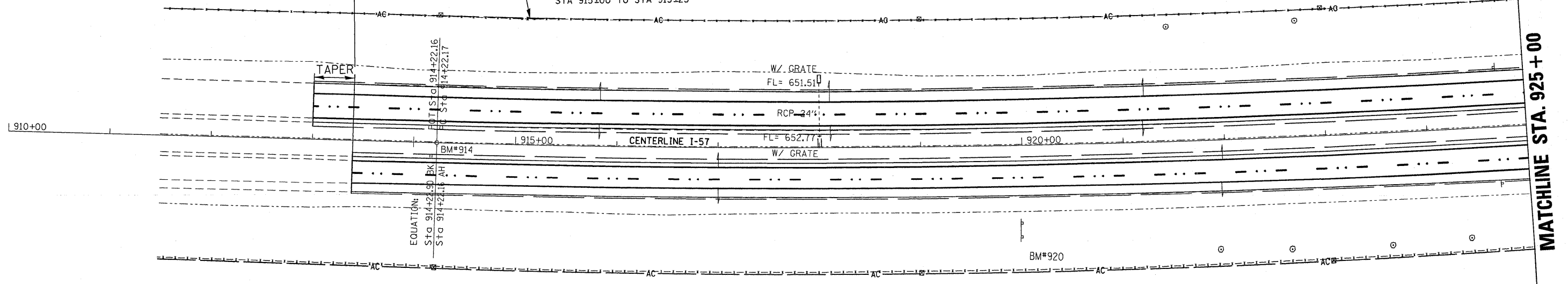

BM 914
P.C. BRASS PLUG IN C I-57 AT
STA. 914+22.84
ELEV. = 651.86

BM 920
60d NAIL IN FENCE POST AT
STA. 920+00, 125' RT.
ELEV. = 657.16

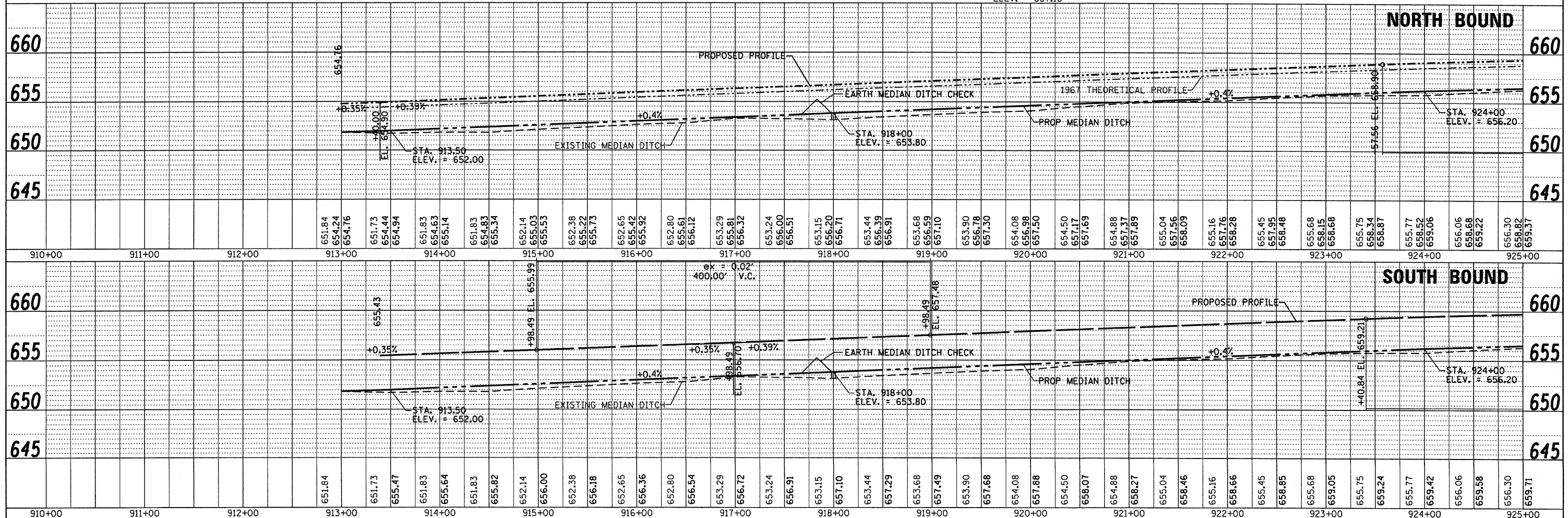
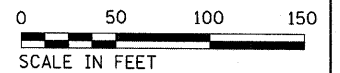

FILE NAME =	USER NAME = duncanbd	DESIGNED -	REVISED -	<p align="center">STATE OF ILLINOIS DEPARTMENT OF TRANSPORTATION</p> <p>SCALE: 1=50 SHEET NO. 1 OF 18 SHEETS STA. 910+00 TO STA. 925+00</p>	<p align="center">PLAN & PROFILE</p>		F.A.I. RTE.	SECTION	COUNTY	TOTAL SHEETS	SHEET NO.
c:\pwork\PWIDOT\DUNCANBD\dms30392\ep05	05-shr-plnprf-main.dgn	CHECKED -	REVISED -		57	(38-1,2)RS-2 & I	IROQUOIS	263	22		
PLOT SCALE = 50,0000 / IN.		DRAWN -	REVISED -		CONTRACT NO. 66981						
PLOT DATE = Oct 21, 2009 - 09:29:26 AM		CHECKED -	REVISED -		ILLINOIS FED. AID PROJECT						